

PHOTOSTAKEN OH-2 OH-3
 SECONDARY CRASH OH-1P OTHER
 PRIVATE PROPERTY

LOCAL INFORMATION: **Bellbrook Police Department** NCIC* **0,29,05**

COUNTY* **29** LOCALITY* **1** LOCATION: CITY, VILLAGE, TOWNSHIP* **Bellbrook**

CRASH DATE / TIME* **05272023 1113** CRASH SEVERITY **5**

ROUTE TYPE: **DR** LOCATION ROAD NAME: **Possum Run** LATITUDE DECIMAL DEGREES: **39.653100**

REFERENCE ROAD NAME (ROAD, MILEPOST, HOUSE #): **4250** LONGITUDE DECIMAL DEGREES: **-84.097800**

REFERENCE POINT **3** DIRECTION FROM REFERENCE: **1-NORTH**

ROUTE TYPE: **IR** ROAD TYPE: **HW**

INTERSECTION RELATED: WITHIN INTERSECTION OR ON APPROACH

LOCATION OF FIRST HARMFUL EVENT **02** MANNER OF CRASH COLLISION/IMPACT **2**

DIRECTION OF TRAVEL: **1-NORTH** MEDIAN TYPE: **1-DIVIDED FLUSH MEDIAN (<4 FEET)**

WORK ZONE RELATED: WORKERS PRESENT: LAW ENFORCEMENT PRESENT: ACTIVE SCHOOL ZONE:

WORK ZONE TYPE: **1-LANE CLOSURE**

LOCATION OF CRASH IN WORK ZONE: **1-BEFORE THE 1ST WORK ZONE WARNING SIGN**

CONTOUR: **1** CONDITIONS: **1** SURFACE: **2**

LIGHT CONDITION: **1** WEATHER: **1**

NARRATIVE

On 05/27/2023, Unit#1 (OH reg. HIJ3108) was traveling Westbound on Possum Run from Kensington. Unit#2 (OH reg. JHE2646) was legally parked in front of 4250 Possum Run. Unit#2 occupied facing Westbound on Possum Run. Unit #1 left the lane of travel and crossed over to the right side of the roadway on Possum Run. Unit#1 then rear ended Unit#2 in front of 4250 Possum Run.

Body Cam active

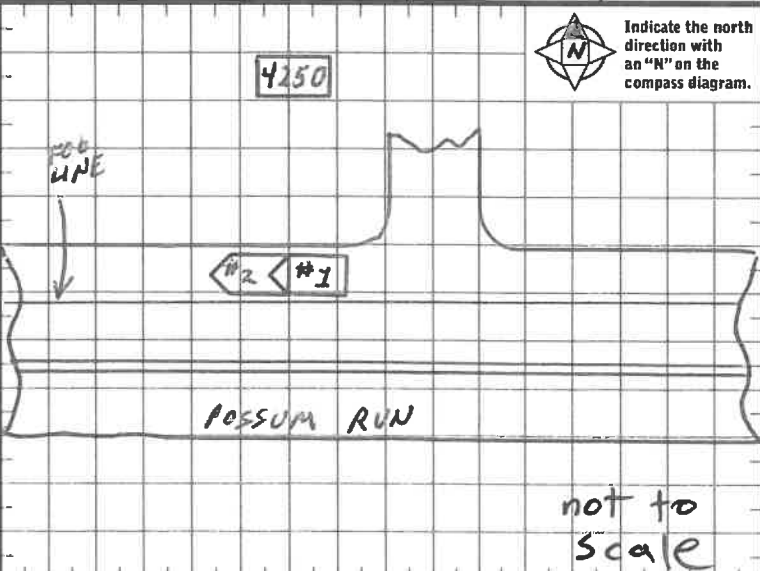

CRASH REPORTED DATE / TIME: **05272023 1113** DISPATCH DATE / TIME: **05272023 1113** ARRIVAL DATE / TIME: **05272023 1113** SCENE CLEARED DATE / TIME: **05272023 1213**

REPORT TAKEN BY: POLICE AGENCY MOTORIST SUPPLEMENT

TOTAL TIME ROADWAY CLOSED: **1** OTHER INVESTIGATION TIME: **60** TOTAL MINUTES: **120**

OFFICER'S NAME*: **Ruble, Anthony** OFFICER'S BADGE NUMBER*: **1 3**

CHECKED BY OFFICER'S NAME*: **Dgt. J. Vetter** CHECKED BY OFFICER'S BADGE NUMBER*: **3 3**

OWNER

UNIT # 01 OWNER NAME: LAST, FIRST, MIDDLE (X SAME AS DRIVER) OWNER PHONE: INCLUDE AREA CODE (X SAME AS DRIVER)

OWNER ADDRESS: STREET, CITY, STATE, ZIP (X SAME AS DRIVER)

COMMERCIAL CARRIER: NAME, ADDRESS, CITY, STATE, ZIP COMMERCIAL CARRIER PHONE: INCLUDE AREA CODE

DAMAGE

DAMAGE SCALE

4 1 - NONE 3 - FUNCTIONAL DAMAGE
2 - MINOR DAMAGE 4 - DISABLING DAMAGE
9 - UNKNOWN

VEHICLE

LP STATE OH LICENSE PLATE # HIJ3108 VEHICLE IDENTIFICATION # 1GYKNERS3JZ184515 VEHICLE YEAR 2018 VEHICLE MAKE CADI

INSURANCE VERIFIED Allstate INSURANCE POLICY # 980227472 COLOR TAN VEHICLE MODEL STS

COMMERCIAL GOVERNMENT IN EMERGENCY RESPONSE TYPE OF USE

INTERLOCK DEVICE EQUIPPED HIT/SKIP UNIT #OCCUPANTS 01 VEHICLE WEIGHT GVWR/GCWR 1 HAZARDOUS MATERIAL CLASS # PLACARD ID #

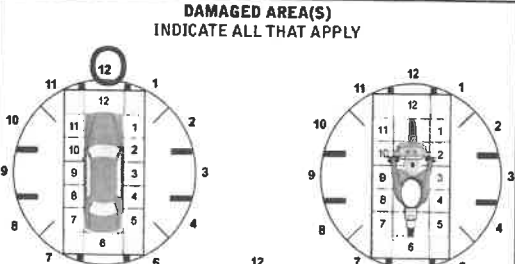

UNIT TYPE 03 # OF TRAILING UNITS 0

1 - PASSENGER CAR 7 - MOTORCYCLE 2-WHEELED 12 - GOLF CART 18 - LIMO (LIVERY VEHICLE) 23 - PEDESTRIAN / SKATER
2 - PASSENGER VAN (MINIVAN) 8 - MOTORCYCLE 3-WHEELED 13 - SNOWMOBILE 19 - BUS (16+ PASSENGERS) 24 - WHEELCHAIR (ANY TYPE)
3 - SPORT UTILITY VEHICLE 9 - AUTOCYCLE 14 - SINGLE UNIT TRUCK 20 - OTHER VEHICLE 25 - OTHER NON-MOTORIST
4 - PICK UP 10 - MOPED OR MOTORIZED BICYCLE 15 - SEMI-TRACTOR 21 - HEAVY EQUIPMENT 26 - BICYCLE
5 - CARGO VAN 11 - ALL TERRAIN VEHICLE (ATV / UTV) 16 - FARM EQUIPMENT 22 - ANIMAL WITH RIDER OR ANIMAL-DRAWN VEHICLE 27 - TRAIN
6 - VAN (9-15 SEATS) 17 - MOTORHOME 99 - UNKNOWN OR HITSKIP

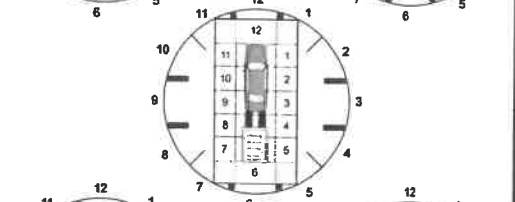

WAS VEHICLE OPERATING IN AUTONOMOUS MODE WHEN CRASH OCCURRED? 0 AUTONOMOUS MODE LEVEL

1 - YES 2 - NO 9 - OTHER / UNKNOWN 0 - NO AUTOMATION 1 - DRIVER ASSISTANCE 3 - CONDITIONAL AUTOMATION 4 - HIGH AUTOMATION 5 - FULL AUTOMATION 9 - UNKNOWN 2 - PARTIAL AUTOMATION

SPECIAL FUNCTION 01

1 - NONE 6 - BUS - CHARTER/TOUR 11 - FIRE 16 - FARM 21 - MAIL CARRIER
2 - TAXI 7 - BUS - INTERCITY 12 - MILITARY 17 - MOWING 99 - OTHER / UNKNOWN
3 - ELECTRONIC RIDE SHARING 8 - BUS - SHUTTLE 13 - POLICE 18 - SNOW REMOVAL
4 - SCHOOL TRANSPORT 9 - BUS - OTHER 14 - PUBLIC UTILITY 19 - TOWING
5 - BUS - TRANSIT/COMMUTER 10 - AMBULANCE 15 - CONSTRUCTION EQUIPMENT 20 - SAFETY SERVICE PATROL

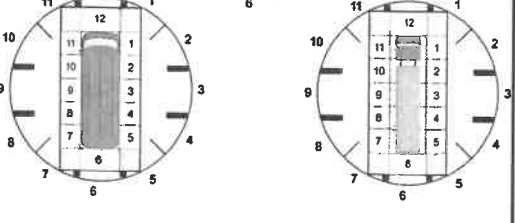

CARGO BODY TYPE 01

1 - NO CARGO BODY TYPE / NOT APPLICABLE 3 - VEHICLE TOWING ANOTHER MOTOR VEHICLE 5 - INTERMODAL CONTAINER CHASSIS 8 - POLE 12 - CONCRETE MIXER
2 - BUS 4 - LOGGING 6 - CARGO VAN/ENCLOSED BOX 7 - GRAIN/CHIPS/GRAVEL 9 - CARGO TANK 10 - FLAT BED 11 - DUMP 13 - AUTO TRANSPORTER 14 - GARBAGE/REFUSE 99 - OTHER / UNKNOWN

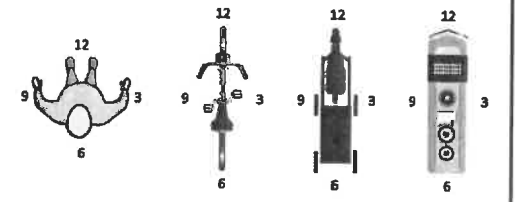

VEHICLE DEFECTS

1 - TURN SIGNALS 4 - BRAKES 7 - WORN OR SLICK TIRES 9 - MOTOR TROUBLE 99 - OTHER / UNKNOWN
2 - HEAD LAMPS 5 - STEERING 8 - TRAILER EQUIPMENT DEFECTIVE 10 - DISABLED FROM PRIOR ACCIDENT
3 - TAIL LAMPS 6 - TIRE BLOWOUT

NO DAMAGE [0] UNDERCARRIAGE [14]
 TOP [13] ALL AREAS [15]
 UNIT NOT AT SCENE [16]

NON-MOTORIST LOCATION AT IMPACT

1 - INTERSECTION - MARKED CROSSWALK 3 - INTERSECTION - OTHER 6 - BICYCLE LANE 9 - MEDIAN/CROSSING ISLAND 12 - FIRST RESPONDER AT INCIDENT SCENE
2 - INTERSECTION - UNMARKED CROSSWALK 4 - OVERTAKING / PASSING 7 - SHOULDER / ROADSIDE 10 - DRIVEWAY ACCESS 11 - SHARED USE PATHS OR TRAILS 99 - OTHER / UNKNOWN
5 - TRAVEL LANE - OTHER LOCATION 8 - SIDEWALK 11 - SHARED USE PATHS OR TRAILS

ACTION 3 **PRE-CRASH ACTIONS** 09

1 - NON-CONTACT 2 - NON-COLLISION 3 - STRIKING 4 - STRUCK & STRUCK 5 - BOTH STRIKING & STRUCK 9 - OTHER / UNKNOWN
1 - STRAIGHT AHEAD 2 - BACKING 3 - CHANGING LANES 4 - OVERTAKING/PASSING 5 - MAKING RIGHT TURN 6 - MAKING LEFT TURN
7 - MAKING U-TURN 8 - ENTERING TRAFFIC LANE 9 - LEAVING TRAFFIC LANE 10 - PARKED 11 - SLOWING OR STOPPED IN TRAFFIC 12 - DRIVERLESS
13 - NEGOTIATING A CURVE 14 - ENTERING OR CROSSING SPECIFIED LOCATION 15 - WALKING, RUNNING, JOGGING, PLAYING 16 - WORKING 17 - PUSHING VEHICLE
18 - APPROACHING OR LEAVING VEHICLE 19 - STANDING 20 - OTHER NON-MOTORIST 21 - STANDING OUTSIDE DISABLED VEHICLE 99 - OTHER / UNKNOWN

INITIAL POINT OF CONTACT

12 0 - NO DAMAGE 14 - UNDERCARRIAGE
1-12 - REFER TO UNIT DIAGRAM 15 - VEHICLE NOT AT SCENE
13 - TOP 99 - UNKNOWN

CONTRIBUTING CIRCUMSTANCES 99

1 - NONE 7 - LEFT OF CENTER 13 - IMPROPER START FROM A PARKED POSITION 17 - VISION OBSTRUCTION 21 - LYING IN ROADWAY
2 - FAILURE TO YIELD 8 - FOLLOWING TOO CLOSE / ACDA 14 - STOPPED OR PARKED ILLEGALLY 18 - OPERATING DEFECTIVE EQUIPMENT 22 - NOT DISCERNIBLE
3 - RAN RED LIGHT 9 - IMPROPER LANE CHANGE 15 - SWERVING TO AVOID 19 - LOAD SHIFTING/FALLING/SPILLING 23 - OPENING DOOR INTO ROADWAY
4 - RAN STOP SIGN 10 - IMPROPER PASSING 16 - WRONG WAY 20 - IMPROPER CROSSING 99 - OTHER IMPROPER ACTION
5 - UNSAFE SPEED 11 - DROVE OFF ROAD
6 - IMPROPER TURN 12 - IMPROPER BACKING

TRAFFIC

TRAFFICWAY FLOW 2 1 - ONE-WAY 2 - TWO-WAY

TRAFFIC CONTROL 06 1 - ROUNDABOUT 4 - STOP SIGN 2 - SIGNAL 5 - YIELD SIGN 3 - FLASHER 6 - NO CONTROL

SEQUENCE OF EVENTS

20 1 - OVERTURN/ROLLOVER 2 - FIRE/EXPLOSION 3 - IMMERSION 4 - JACKKNIFE 5 - CARGO / EQUIPMENT LOSS OR SHIFT

EVENTS

6 - EQUIPMENT FAILURE 7 - SEPARATION OF UNITS 8 - RAN OFF ROAD RIGHT 9 - RAN OFF ROAD LEFT 10 - CROSS MEDIAN
11 - CROSS CENTERLINE - OPPOSITE DIRECTION OF TRAVEL 12 - DOWNHILL RUNAWAY 13 - OTHER NON-COLLISION 14 - PEDESTRIAN 15 - PEDALCYCLE
16 - RAILWAY VEHICLE 17 - ANIMAL - FARM 18 - ANIMAL - DEER 19 - ANIMAL - OTHER 20 - MOTOR VEHICLE IN TRANSPORT 21 - PARKED MOTORVEHICLE
22 - WORK ZONE MAINTENANCE EQUIPMENT 23 - STRUCK BY FALLING, SHIFTING CARGO OR ANYTHING SET IN MOTION BY A MOTOR VEHICLE 24 - OTHER MOVABLE OBJECT

OF THROUGH LANES ON ROAD 2

RAIL GRADE CROSSING

1 - NOT INVOLVED 2 - INVOLVED-ACTIVE CROSSING 3 - INVOLVED-PASSIVE CROSSING

COLLISION WITH FIXED OBJECT - STRUCK

25 - IMPACT ATTENUATOR / CRASH CUSHION 26 - BRIDGE OVERHEAD STRUCTURE 27 - BRIDGE PIER OR ABUTMENT 28 - BRIDGE PARAPET 29 - BRIDGE RAIL 30 - GUARDRAIL FACE
31 - GUARDRAIL END 32 - PORTABLE BARRIER 33 - MEDIAN CABLE BARRIER 34 - MEDIAN GUARDRAIL BARRIER 35 - MEDIAN CONCRETE BARRIER 36 - MEDIAN OTHER BARRIER
37 - TRAFFIC SIGN POST 38 - OVERHEAD SIGN POST 39 - LIGHT / LUMINARIES SUPPORT 40 - UTILITY POLE 41 - OTHER POST, POLE OR SUPPORT 42 - CULVERT
43 - CURB 44 - DITCH 45 - EMBANKMENT 46 - FENCE 47 - MAILBOX 48 - TREE 49 - FIRE HYDRANT
50 - WORK ZONE MAINTENANCE EQUIPMENT 51 - WALL 52 - BUILDING 53 - TUNNEL 54 - OTHER FIXED OBJECT 99 - OTHER / UNKNOWN

FIRST HARMFUL EVENT 1 **MOST HARMFUL EVENT** 1

UNIT / NON-MOTORIST DIRECTION

FROM 3 TO 4

1 - NORTH 5 - NORTHEAST 2 - SOUTH 6 - NORTHWEST 3 - EAST 7 - SOUTHEAST 4 - WEST 8 - SOUTHWEST 9 - OTHER / UNKNOWN

UNIT SPEED 024

POSTED SPEED 25

DETECTED SPEED 1 1 - STATED / ESTIMATED SPEED 2 - CALCULATED / EDR 3 - UNDETERMINED

UNIT # 02 OWNER NAME: LAST, FIRST, MIDDLE (SAME AS DRIVER) SCHWIETERMAN, JOHN J III OWNER PHONE: INCLUDE AREA CODE (SAME AS DRIVER) OWNER ADDRESS: STREET, CITY, STATE, ZIP (SAME AS DRIVER) 4250 POSSUM RUN RD DAYTON OH 45440 4056 COMMERCIAL CARRIER: NAME, ADDRESS, CITY, STATE, ZIP COMMERCIAL CARRIER PHONE: INCLUDE AREA CODE

DAMAGE DAMAGE SCALE 4 1 - NONE 2 - MINOR DAMAGE 3 - FUNCTIONAL DAMAGE 4 - DISABLING DAMAGE 9 - UNKNOWN

LP STATE OH LICENSE PLATE # JHE2646 VEHICLE IDENTIFICATION # 3FA6P0RU5KR227091 VEHICLE YEAR 2019 VEHICLE MAKE FORD INSURANCE VERIFIED [X] INSURANCE COMPANY Geico INSURANCE POLICY # 6005676231 COLOR WHT VEHICLE MODEL FUS TYPE OF USE [] COMMERCIAL [] GOVERNMENT [] IN EMERGENCY RESPONSE [] INTERLOCK DEVICE EQUIPPED [] HIT/SKIP UNIT [] #OCCUPANTS 00 US DOT # 1 VEHICLE WEIGHT GVWR/GCWR 1 - <=10K LBS. 2 - 10,001 - 26K LBS. 3 - >26K LBS. HAZARDOUS MATERIAL CLASS # PLACARD ID #

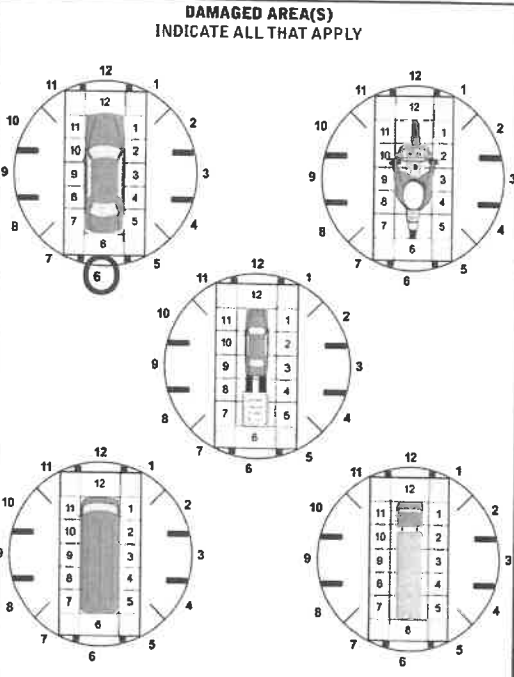

UNIT TYPE 01 # OF TRAILING UNITS 0 WAS VEHICLE OPERATING IN AUTONOMOUS MODE WHEN CRASH OCCURRED? 2 AUTONOMOUS MODE LEVEL 0

SPECIAL FUNCTION 01 CARGO BODY TYPE 1 - NO CARGO BODY TYPE / NOT APPLICABLE 2 - BUS 3 - VEHICLE TOWING ANOTHER MOTOR VEHICLE 4 - LOGGING 5 - INTERMODAL CONTAINER CHASSIS 6 - CARGO VAN/ENCLOSED BOX 7 - GRAIN/CHIPS/GRAVEL 8 - POLE 9 - CARGO TANK 10 - FLAT BED 11 - DUMP 12 - CONCRETE MIXER 13 - AUTO TRANSPORTER 14 - GARBAGE/REFUSE 99 - OTHER / UNKNOWN

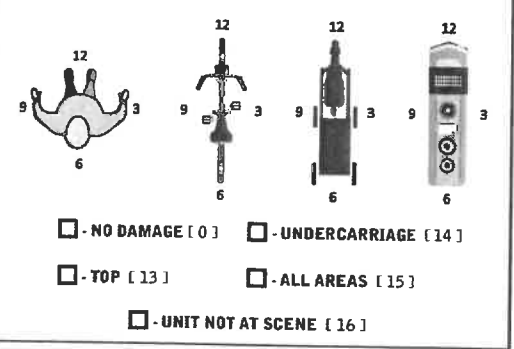

VEHICLE DEFECTS 1 - TURN SIGNALS 2 - HEAD LAMPS 3 - TAIL LAMPS 4 - BRAKES 5 - STEERING 6 - TIRE BLOWOUT 7 - WORN OR SLICK TIRES 8 - TRAILER EQUIPMENT DEFECTIVE 9 - MOTOR TROUBLE 10 - DISABLED FROM PRIOR ACCIDENT 9 - OTHER / UNKNOWN

NON-MOTORIST LOCATION AT IMPACT 4 ACTION 10 PRE-CRASH ACTIONS 1 - NON-CONTACT 2 - NON-COLLISION 3 - STRIKING 4 - STRUCK 5 - BOTH STRIKING & STRUCK 9 - OTHER / UNKNOWN 1 - STRAIGHT AHEAD 2 - BACKING 3 - CHANGING LANES 4 - OVERTAKING/PASSING 5 - MAKING RIGHT TURN 6 - MAKING LEFT TURN 7 - MAKING U-TURN 8 - ENTERING TRAFFIC LANE 9 - LEAVING TRAFFIC LANE 10 - PARKED 11 - SLOWING OR STOPPED IN TRAFFIC 12 - DRIVERLESS 13 - NEGOTIATING A CURVE 14 - ENTERING OR CROSSING SPECIFIED LOCATION 15 - WALKING, RUNNING, JOGGING, PLAYING 16 - WORKING 17 - PUSHING VEHICLE 18 - APPROACHING OR LEAVING VEHICLE 19 - STANDING 20 - OTHER NON-MOTORIST 21 - STANDING OUTSIDE DISABLED VEHICLE 99 - OTHER / UNKNOWN

INITIAL POINT OF CONTACT 6 0 - NO DAMAGE 14 - UNDERCARRIAGE 15 - VEHICLE NOT AT SCENE 13 - TOP 99 - UNKNOWN

CONTRIBUTING CIRCUMSTANCES 01 SEQUENCE OF EVENTS 21 1 - OVERTURN/ROLLOVER 2 - FIRE/EXPLOSION 3 - IMMERSION 4 - JACKKNIFE 5 - CARGO / EQUIPMENT LOSS OR SHIFT 6 - EQUIPMENT FAILURE 7 - SEPARATION OF UNITS 8 - RAN OFF ROAD RIGHT 9 - RAN OFF ROAD LEFT 10 - CROSS MEDIAN 11 - CROSS CENTERLINE - OPPOSITE DIRECTION OF TRAVEL 12 - DOWNHILL RUNAWAY 13 - OTHER NON-COLLISION 14 - PEDESTRIAN 15 - PEDALCYCLE 16 - RAILWAY VEHICLE 17 - ANIMAL - FARM 18 - ANIMAL - DEER 19 - ANIMAL - OTHER 20 - MOTOR VEHICLE IN TRANSPORT 21 - PARKED MOTOR VEHICLE 22 - WORK ZONE MAINTENANCE EQUIPMENT 23 - STRUCK BY FALLING, SHIFTING CARGO OR ANYTHING SET IN MOTION BY A MOTOR VEHICLE 24 - OTHER MOVABLE OBJECT

TRAFFIC TRAFFICWAY FLOW 2 TRAFFIC CONTROL 06 # OF THROUGH LANES ON ROAD 2 RAIL GRADE CROSSING 3

COLLISION WITH FIXED OBJECT - STRUCK 1 1 - IMPACT ATTENUATOR / CRASH CUSHION 2 - BRIDGE OVERHEAD STRUCTURE 3 - BRIDGE PIER OR ABUTMENT 4 - BRIDGE PARAPET 5 - BRIDGE RAIL 6 - GUARDRAIL FACE 31 - GUARDRAIL END 32 - PORTABLE BARRIER 33 - MEDIAN CABLE BARRIER 34 - MEDIAN GUARDRAIL BARRIER 35 - MEDIAN CONCRETE BARRIER 36 - MEDIAN OTHER BARRIER 37 - TRAFFIC SIGN POST 38 - OVERHEAD SIGN POST 39 - LIGHT / LUMINARIES SUPPORT 40 - UTILITY POLE 41 - OTHER POST, POLE OR SUPPORT 42 - CULVERT 43 - CURB 44 - DITCH 45 - EMBANKMENT 46 - FENCE 47 - MAILBOX 48 - TREE 49 - FIRE HYDRANT 50 - WORK ZONE MAINTENANCE EQUIPMENT 51 - WALL 52 - BUILDING 53 - TUNNEL 54 - OTHER FIXED OBJECT 99 - OTHER / UNKNOWN

UNIT / NON-MOTORIST DIRECTION FROM 3 TO 4 1 - NORTH 2 - SOUTH 3 - EAST 4 - WEST 5 - NORTHEAST 6 - NORTHWEST 7 - SOUTHEAST 8 - SOUTHWEST 9 - OTHER / UNKNOWN

FIRST HARMFUL EVENT 1 MOST HARMFUL EVENT 1

UNIT SPEED 000 POSTED SPEED 25 DETECTED SPEED 1 1 - STATED / ESTIMATED SPEED 2 - CALCULATED / EDR 3 - UNDETERMINED

UNIT # 01	NAME: LAST, FIRST, MIDDLE SMITH, SHARON		DATE OF BIRTH 04251953		AGE 70	GENDER F			
ADDRESS: STREET, CITY, STATE, ZIP 3895 N Field Dr Bellbrook OH 45305 2901				CONTACT PHONE - INCLUDE AREA CODE					
INJURIES 5	INJURED TAKEN BY	EMS AGENCY (NAME)	INJURED TAKEN TO: MEDICAL FACILITY (NAME, CITY)	SAFETY EQUIPMENT USED 04	<input type="checkbox"/> DOT-COMPLIANT MC HELMET	SEATING POSITION 01	AIR BAG USAGE 1	EJECTION 1	TRAPPED 1
OL STATE	OPERATOR LICENSE NUMBER		OFFENSE CHARGED 4511.202	LOCAL CODE <input type="checkbox"/>	OFFENSE DESCRIPTION Failure To Control		CITATION NUMBER 32392		
OL CLASS	ENDORSEMENT SELECT UP TO 2	RESTRICTION SELECT UP TO 3	DRIVER DISTRACTED BY 1	ALCOHOL / DRUG SUSPECTED <input type="checkbox"/> ALCOHOL <input type="checkbox"/> MARIJUANA <input type="checkbox"/> OTHER DRUG		CONDITION 1	ALCOHOL TEST STATUS: 1, TYPE: 1, VALUE: .		DRUG TEST(S) STATUS: 1, TYPE: 1, RESULT: SELECT UP TO 4

UNIT #	NAME: LAST, FIRST, MIDDLE		DATE OF BIRTH		AGE	GENDER			
ADDRESS: STREET, CITY, STATE, ZIP				CONTACT PHONE - INCLUDE AREA CODE					
INJURIES	INJURED TAKEN BY	EMS AGENCY (NAME)	INJURED TAKEN TO: MEDICAL FACILITY (NAME, CITY)	SAFETY EQUIPMENT USED	<input type="checkbox"/> DOT-COMPLIANT MC HELMET	SEATING POSITION	AIR BAG USAGE	EJECTION	TRAPPED
OL STATE	OPERATOR LICENSE NUMBER		OFFENSE CHARGED	LOCAL CODE <input type="checkbox"/>	OFFENSE DESCRIPTION		CITATION NUMBER		
OL CLASS	ENDORSEMENT SELECT UP TO 2	RESTRICTION SELECT UP TO 3	DRIVER DISTRACTED BY	ALCOHOL / DRUG SUSPECTED <input type="checkbox"/> ALCOHOL <input type="checkbox"/> MARIJUANA <input type="checkbox"/> OTHER DRUG		CONDITION	ALCOHOL TEST STATUS: , TYPE: , VALUE: .		DRUG TEST(S) STATUS: , TYPE: , RESULT: SELECT UP TO 4

UNIT #	NAME: LAST, FIRST, MIDDLE		DATE OF BIRTH		AGE	GENDER			
ADDRESS: STREET, CITY, STATE, ZIP				CONTACT PHONE - INCLUDE AREA CODE					
INJURIES	INJURED TAKEN BY	EMS AGENCY (NAME)	INJURED TAKEN TO: MEDICAL FACILITY (NAME, CITY)	SAFETY EQUIPMENT USED	<input type="checkbox"/> DOT-COMPLIANT MC HELMET	SEATING POSITION	AIR BAG USAGE	EJECTION	TRAPPED
OL STATE	OPERATOR LICENSE NUMBER		OFFENSE CHARGED	LOCAL CODE <input type="checkbox"/>	OFFENSE DESCRIPTION		CITATION NUMBER		
OL CLASS	ENDORSEMENT SELECT UP TO 2	RESTRICTION SELECT UP TO 3	DRIVER DISTRACTED BY	ALCOHOL / DRUG SUSPECTED <input type="checkbox"/> ALCOHOL <input type="checkbox"/> MARIJUANA <input type="checkbox"/> OTHER DRUG		CONDITION	ALCOHOL TEST STATUS: , TYPE: , VALUE: .		DRUG TEST(S) STATUS: , TYPE: , RESULT: SELECT UP TO 4

INJURIES	SEATING POSITION	AIR BAG	OL CLASS	OL RESTRICTION(S)	DRIVER DISTRACTION	TEST STATUS
1 - FATAL	1 - FRONT - LEFT SIDE (MOTORCYCLE DRIVER)	1 - NOT DEPLOYED	1 - CLASS A	1 - ALCOHOL INTERLOCK DEVICE	1 - NOT DISTRACTED	1 - NONE GIVEN
2 - SUSPECTED SERIOUS INJURY	2 - FRONT - MIDDLE	2 - DEPLOYED FRONT	2 - CLASS B	2 - CDL INTRASTATE ONLY	2 - MANUALLY OPERATING AN ELECTRONIC COMMUNICATION DEVICE (TEXTING, TYPING, DIALING)	2 - TEST REFUSED
3 - SUSPECTED MINOR INJURY	3 - FRONT - RIGHT SIDE	3 - DEPLOYED SIDE	3 - CLASS C	3 - CORRECTIVE LENSES	3 - TALKING ON HANDS-FREE COMMUNICATION DEVICE	3 - TEST GIVEN, CONTAMINATED SAMPLE / UNUSABLE
4 - POSSIBLE INJURY	4 - SECOND - LEFT SIDE (MOTORCYCLE PASSENGER)	4 - DEPLOYED BOTH FRONT / SIDE	4 - REGULAR CLASS (OHIO = D)	4 - FARM WAIVER	4 - TALKING ON HAND-HELD COMMUNICATION DEVICE	4 - TEST GIVEN, RESULTS KNOWN
5 - NO APPARENT INJURY	5 - SECOND - MIDDLE	5 - NOT APPLICABLE	5 - M/C MOPED ONLY	5 - EXCEPT CLASS A BUS	5 - OTHER ACTIVITY WITH AN ELECTRONIC DEVICE	5 - TEST GIVEN, RESULTS UNKNOWN
INJURED TAKEN BY		EJECTION		ALCOHOL TEST TYPE		
1 - NOT TRANSPORTED / TREATED AT SCENE	6 - SECOND - RIGHT SIDE	1 - NOT EJECTED	H - HAZMAT	6 - EXCEPT CLASS A & CLASS B BUS	1 - NONE	
2 - EMS	7 - THIRD - LEFT SIDE (MOTORCYCLE SIDE CAR)	2 - PARTIALLY EJECTED	M - MOTORCYCLE	7 - EXCEPT TRACTOR-TRAILER	2 - BLOOD	
3 - POLICE	8 - THIRD - MIDDLE	3 - TOTALLY EJECTED	P - PASSENGER	8 - INTERMEDIATE LICENSE RESTRICTIONS	3 - URINE	
9 - OTHER / UNKNOWN	9 - THIRD - RIGHT SIDE	4 - NOT APPLICABLE	N - TANKER	9 - LEARNER'S PERMIT RESTRICTIONS	4 - BREATH	
SAFETY EQUIPMENT		TRAPPED		DRUG TEST TYPE		
1 - NONE USED	10 - SLEEPER SECTION OF TRUCK CAB	1 - NOT TRAPPED	Q - MOTOR SCOOTER	10 - LIMITED TO DAYLIGHT ONLY	1 - NONE	
2 - SHOULDER BELT ONLY USED	11 - PASSENGER IN OTHER ENCLOSED CARGO AREA (NON-TRAILING UNIT, BUS, PICK-UP WITH CAP)	2 - EXTRICATED BY MECHANICAL MEANS	R - THREE-WHEEL MOTORCYCLE	11 - LIMITED TO EMPLOYMENT	2 - BLOOD	
3 - LAP BELT ONLY USED	12 - PASSENGER IN UNENCLOSED CARGO AREA	3 - FREED BY NON-MECHANICAL MEANS	S - SCHOOL BUS	12 - LIMITED - OTHER	3 - URINE	
4 - SHOULDER & LAP BELT USED	13 - TRAILING UNIT		T - DOUBLE & TRIPLE TRAILERS	13 - MECHANICAL DEVICES (SPECIAL BRAKES, HAND CONTROLS, OR OTHER ADAPTIVE DEVICES)	4 - BREATH	
5 - CHILD RESTRAINT SYSTEM - FORWARD FACING	14 - RIDING ON VEHICLE EXTERIOR (NON-TRAILING UNIT)		X - TANKER / HAZMAT	14 - MILITARY VEHICLES ONLY	5 - OTHER	
6 - CHILD RESTRAINT SYSTEM - REAR FACING	15 - NON-MOTORIST	GENDER		15 - MOTOR VEHICLES WITHOUT AIR BRAKES	DRUG TEST RESULT(S)	
7 - BOOSTER SEAT	99 - OTHER / UNKNOWN	F - FEMALE		16 - OUTSIDE MIRROR	1 - AMPHETAMINES	
8 - HELMET USED		M - MALE		17 - PROSTHETIC AID	2 - BARBITURATES	
9 - PROTECTIVE PADS USED (ELBOW, KNEES, ETC.)		U - OTHER / UNKNOWN		18 - OTHER	3 - BENZODIAZEPINES	
10 - REFLECTIVE CLOTHING					4 - CANNABINOIDS	
11 - LIGHTING - PEDESTRIAN / BICYCLE ONLY					5 - COCAINE	
99 - OTHER / UNKNOWN					6 - OPIATES / OPIOIDS	
					7 - OTHER	
					8 - NEGATIVE RESULTS	