

TRAFFIC CRASH REPORT

*DENOTES MANDATORY FIELD FOR SUPPLEMENT REPORT

LOCAL REPORT NUMBER*
2023-00005864

PHOTOS TAKEN
 SECONDARY CRASH
 OH-2
 OH-1P
 OTHER
 PRIVATE PROPERTY

LOCAL INFORMATION
REPORTING AGENCY NAME*
Bellbrook Police
NCIC*
02905

HIT/SKIP
1 - SOLVED
2 - UNSOLVED
NUMBER OF UNITS
01
UNIT IN ERROR
98 - ANIMAL
99 - UNKNOWN
01

COUNTY*
29
LOCALITY*
1
LOCATION: CITY, VILLAGE, TOWNSHIP*
Bellbrook

LOCATION ROAD NAME
UPPER BELLBROOK
ROAD TYPE
R D

CRASH DATE / TIME*
12082023 2155
CRASH SEVERITY
1 - FATAL
2 - SERIOUS INJURY SUSPECTED
3 - MINOR INJURY SUSPECTED
4 - INJURY POSSIBLE
5 - PROPERTY DAMAGE ONLY
3

ROUTE TYPE
3
ROUTE NUMBER
200
PREFIX
1
DIRECTION FROM REFERENCE
1 - NORTH
2 - SOUTH
3 - EAST
4 - WEST

REFERENCE ROAD NAME (ROAD, MILEPOST, HOUSE #)
3869
ROAD TYPE
R D

LATITUDE DECIMAL DEGREES
39.645638
LONGITUDE DECIMAL DEGREES
-84.066523

REFERENCE POINT
1 - INTERSECTION
2 - MILE POST
3 - HOUSE #
3

ROUTE TYPE
IR - INTERSTATE ROUTE(TP)
US - FEDERAL US ROUTE
SR - STATE ROUTE
CR - NUMBERED COUNTY ROUTE
TR - NUMBERED TOWNSHIP ROUTE

INTERSECTION RELATED
 WITHIN INTERSECTION OR ON APPROACH
 WITHIN INTERCHANGE AREA
NUMBER OF APPROACHES
0

DISTANCE FROM REFERENCE
200
DIRECTION FROM REFERENCE
1

ROAD TYPE
AL - ALLEY
AV - AVENUE
BL - BOULEVARD
CR - CIRCLE
CT - COURT
DR - DRIVE
HE - HEIGHTS
HW - HIGHWAY
LA - LANE
MP - MILEPOST
OV - OVAL
PK - PARKWAY
PI - PIKE
PL - PLACE
RD - ROAD
SQ - SQUARE
ST - STREET
TE - TERRACE
TL - TRAIL
WA - WAY

ROADWAY
 ROADWAY DIVIDED

LOCATION OF FIRST HARMFUL EVENT
1 - ON ROADWAY
2 - ON SHOULDER
3 - IN MEDIAN
4 - ON ROADSIDE
5 - ON GORE
6 - OUTSIDE TRAFFIC WAY
7 - ON RAMP
8 - OFF RAMP
06

MANNER OF CRASH COLLISION/IMPACT
1 - NOT COLLISION BETWEEN TWO MOTOR VEHICLES IN TRANSPORT
2 - REAR-END
3 - HEAD-ON
4 - REAR-TO-REAR
5 - BACKING
6 - ANGLE
7 - SIDESWIPE, SAME DIRECTION
8 - SIDESWIPE, OPPOSITE DIRECTION
9 - OTHER / UNKNOWN
1

DIRECTION OF TRAVEL
1 - NORTH
2 - SOUTH
3 - EAST
4 - WEST
MEDIAN TYPE
1 - DIVIDED FLUSH MEDIAN (<4 FEET)
2 - DIVIDED FLUSH MEDIAN (>=4 FEET)
3 - DIVIDED, DEPRESSED MEDIAN (ANY TYPE)
4 - DIVIDED, RAISED MEDIAN (ANY TYPE)
9 - OTHER/UNKNOWN

WORK ZONE RELATED
 WORKERS PRESENT
 LAW ENFORCEMENT PRESENT
 ACTIVE SCHOOL ZONE

WORK ZONE TYPE
1 - LANE CLOSURE
2 - LANE SHIFT/CROSSOVER
3 - WORK ON SHOULDER OR MEDIAN
4 - INTERMITTENT OR MOVING WORK
5 - OTHER
LOCATION OF CRASH IN WORK ZONE
1 - BEFORE THE 1ST WORK ZONE WARNING SIGN
2 - ADVANCE WARNING AREA
3 - TRANSITION AREA
4 - ACTIVITY AREA
5 - TERMINATION AREA

CONTOUR
3
CONDITIONS
1
SURFACE
2

LIGHT CONDITION
1 - DAYLIGHT
2 - DAWN/DUSK
3 - DARK - LIGHTED ROADWAY
4 - DARK - ROADWAY NOT LIGHTED
5 - DARK - UNKNOWN ROADWAY LIGHTING
9 - OTHER / UNKNOWN
4

WEATHER
1 - CLEAR
2 - CLOUDY
3 - FOG, SMOG, SMOKE
4 - RAIN
5 - SLEET, HAIL
6 - SNOW
7 - SEVERE CROSSWINDS
8 - BLOWING SAND, SOIL, DIRT, SNOW
9 - FREEZING RAIN OR FREEZING DRIZZLE
99 - OTHER / UNKNOWN
01

1 - STRAIGHT LEVEL
2 - STRAIGHT GRADE
3 - CURVE LEVEL
4 - CURVE GRADE
9 - OTHER/UNKNOWN
1 - DRY
2 - WET
3 - SNOW
4 - ICE
5 - SAND, MUD, DIRT, OIL, GRAVEL
6 - WATER (STANDING, MOVING)
7 - SLUSH
9 - OTHER/UNKNOWN

NARRATIVE
Unit 1 was traveling westbound upon a private drive near 3869 Upper Bellbrook Road, when the driver lost control of vehicle, running off the left side of the roadway striking a tree. Estimated speed was determined based on unit 1 impact with tree causing disabling damages.

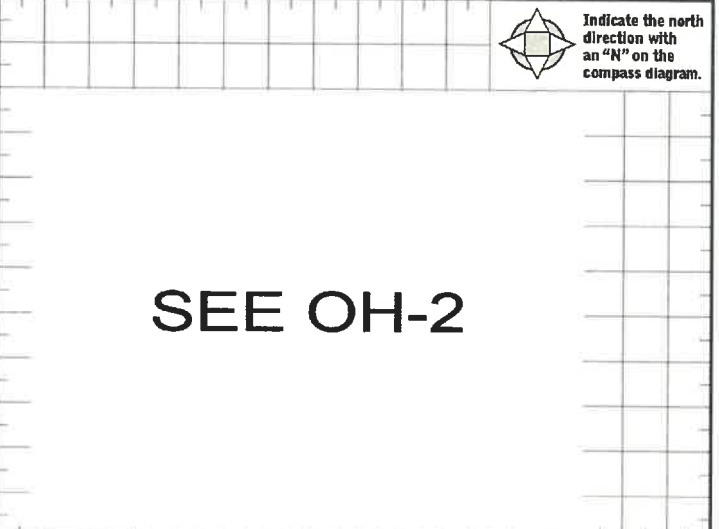

SEE OH-2

CRASH REPORTED DATE / TIME
12082023 2155

DISPATCH DATE / TIME
12082023 2157

ARRIVAL DATE / TIME
12082023 2202

SCENE CLEARED DATE / TIME
12082023 2249

REPORT TAKEN BY
 POLICE AGENCY
 MOTORIST

TOTAL TIME ROADWAY CLOSED
0
OTHER INVESTIGATION TIME
20
TOTAL MINUTES
72

OFFICER'S NAME*
Williams
OFFICER'S BADGE NUMBER*
B B 4 2

CHECKED BY OFFICER'S NAME*
Lane
CHECKED BY OFFICER'S BADGE NUMBER*
B B 4 8

SUPPLEMENT (CORRECTION OR ADDITION TO AN EXISTING REPORT SENT TO OOSP)

OWNER

UNIT # **01** OWNER NAME: LAST, FIRST, MIDDLE (SAME AS DRIVER)
SFS Leasing,

OWNER ADDRESS: STREET, CITY, STATE, ZIP (SAME AS DRIVER)
4225 Brown RD Road Dayton, OH 45440

COMMERCIAL CARRIER: NAME, ADDRESS, CITY, STATE, ZIP

OWNER PHONE: INCLUDE AREA CODE (SAME AS DRIVER)

COMMERCIAL CARRIER PHONE: INCLUDE AREA CODE

DAMAGE

DAMAGE SCALE

4 1 - NONE 3 - FUNCTIONAL DAMAGE
 2 - MINOR DAMAGE 4 - DISABLING DAMAGE
 9 - UNKNOWN

VEHICLE

LP STATE **OH** LICENSE PLATE # **KBZ9990** VEHICLE IDENTIFICATION # **1C4RJYD6P8794659** VEHICLE YEAR **2023** VEHICLE MAKE **Jeep (after 1988)**

INSURANCE VERIFIED CINCINNATI INSURANCE INSURANCE POLICY # **ETA0496514** COLOR **SIL** VEHICLE MODEL **Grand Cherokee**

COMMERCIAL GOVERNMENT IN EMERGENCY RESPONSE

INTERLOCK DEVICE EQUIPPED HIT/SKIP UNIT #OCCUPANTS **01** VEHICLE WEIGHT GVWR/GCWR
 1 - ≤10K LBS.
 2 - 10,001 - 26K LBS.
 3 - >26K LBS.

TOWED BY: COMPANY NAME **Sandys Towing**

HAZARDOUS MATERIAL CLASS # PLACARD ID #

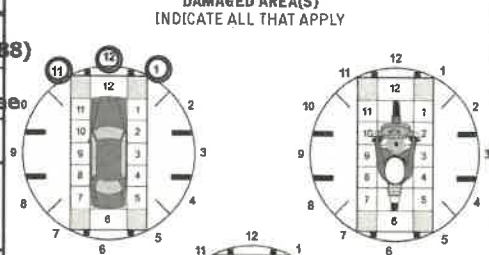

UNIT TYPE **03**

1 - PASSENGER CAR 7 - MOTORCYCLE 2-WHEELED 12 - GOLF CART 18 - LIMO (LIVERY VEHICLE) 23 - PEDESTRIAN / SKATER
 2 - PASSENGER VAN (MINIVAN) 8 - MOTORCYCLE 3-WHEELED 13 - SNOWMOBILE 19 - BUS (6+ PASSENGERS) 24 - WHEELCHAIR (ANY TYPE)
 3 - SPORT UTILITY VEHICLE 9 - AUTOCYCLE 14 - SINGLE UNIT TRUCK 20 - OTHER VEHICLE 25 - OTHER NON-MOTORIST
 4 - PICK UP 10 - MOPED OR MOTORIZED BICYCLE 15 - SEMI-TRACTOR 21 - HEAVY EQUIPMENT 26 - BICYCLE
 5 - CARGO VAN 6 - VAN (9-15 SEATS) 11 - ALL-TERRAIN VEHICLE (ATV/UTV) 16 - FARM EQUIPMENT 22 - ANIMAL WITH RIDER OR ANIMAL-DRAWN VEHICLE 27 - TRAIN
 99 - UNKNOWN OR HIT/SKIP

OF TRAILING UNITS **00**

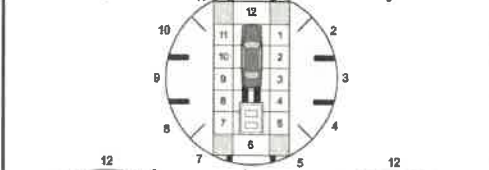

WAS VEHICLE OPERATING IN AUTONOMOUS MODE WHEN CRASH OCCURRED? **0**

1 - YES 2 - NO 9 - OTHER/UNKNOWN

0 - NO AUTOMATION 3 - CONDITIONAL AUTOMATION 9 - UNKNOWN
 1 - DRIVER ASSISTANCE 4 - HIGH AUTOMATION
 2 - PARTIAL AUTOMATION 5 - FULL AUTOMATION

SPECIAL FUNCTION

1 - NONE 6 - BUS - CHARTER/TOUR 11 - FIRE 16 - FARM 21 - MAIL CARRIER
 2 - TAXI 7 - BUS - INTERCITY 12 - MILITARY 17 - MOWING 99 - OTHER/UNKNOWN
 3 - ELECTRONIC RIDE SHARING 8 - BUS - SHUTTLE 13 - POLICE 18 - SNOW REMOVAL
 4 - SCHOOL TRANSPORT 9 - BUS - OTHER 14 - PUBLIC UTILITY 19 - TOWING
 5 - BUS - TRANSIT/COMMUTER 10 - AMBULANCE 15 - CONSTRUCTION EQUIPMENT 20 - SAFETY SERVICE PATROL

CARGO BODY TYPE

1 - NO CARGO BODY TYPE / NOT APPLICABLE 3 - VEHICLE TOWING ANOTHER MOTOR VEHICLE 5 - INTERMODAL CONTAINER CHASSIS 8 - POLE 12 - CONCRETE MIXER
 2 - BUS 4 - LOGGING 6 - CARGO VAN/ENCLOSED BOX 9 - CARGO TANK 13 - AUTO TRANSPORTER
 7 - GRAIN/CHIPS/GRAVEL 10 - FLAT BED 14 - GARBAGE/REFUSE
 11 - DUMP 99 - OTHER/UNKNOWN

VEHICLE DEFECTS

1 - TURN SIGNALS 4 - BRAKES 7 - WORN OR SLICK TIRES 9 - MOTOR TROUBLE 99 - OTHER/UNKNOWN
 2 - HEAD LAMPS 5 - STEERING 8 - TRAILER EQUIPMENT DEFECTIVE 10 - DISABLED FROM PRIOR ACCIDENT
 3 - TAIL LAMPS 6 - TIRE BLOWOUT

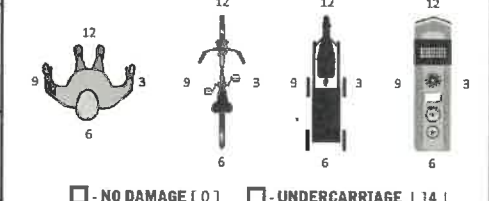
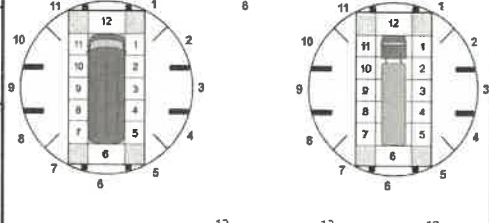

- NO DAMAGE [0] - UNDERCARRIAGE [14]
 - TOP [13] - ALL AREAS [15]
 - UNIT NOT AT SCENE [16]

NON-MOTORIST LOCATION AT IMPACT

1 - INTERSECTION - MARKED CROSSWALK 3 - INTERSECTION - OTHER 6 - BICYCLE LANE 9 - MEDIAN/CROSSING ISLAND 12 - FIRST RESPONDER AT INCIDENT SCENE
 2 - INTERSECTION - UNMARKED CROSSWALK 4 - MIDBLOCK - MARKED CROSSWALK 7 - SHOULDER / ROADSIDE 10 - DRIVEWAY ACCESS 15 - VEHICLE NOT AT SCENE
 5 - TRAVEL LANE - Other Location 8 - SIDEWALK 11 - SHARED USE PATHS OR TRAILS 99 - OTHER/UNKNOWN

ACTION

1 - NON-CONTACT 1 - STRAIGHT AHEAD 7 - MAKING U-TURN 13 - NEGOTIATING A CURVE 18 - APPROACHING OR LEAVING VEHICLE
 2 - NON-COLLISION 2 - BACKING 8 - ENTERING TRAFFIC LANE 14 - ENTERING OR CROSSING SPECIFIED LOCATION 19 - STANDING
 3 - STRIKING 3 - CHANGING LANES 9 - LEAVING TRAFFIC LANE 15 - WALKING, RUNNING, JOGGING, PLAYING 20 - OTHER NON-MOTORIST
 4 - STRUCK 4 - OVERTAKING/PASSING 10 - PARKED 16 - WORKING 21 - STANDING OUTSIDE DISABLED VEHICLE
 5 - BOTH STRIKING & STRUCK 5 - MAKING RIGHT TURN 11 - SLOWING OR STOPPED IN TRAFFIC 17 - PUSHING VEHICLE 99 - OTHER/UNKNOWN
 9 - OTHER/UNKNOWN 6 - MAKING LEFT TURN 12 - DRIVERLESS

INITIAL POINT OF CONTACT

0 - NO DAMAGE 14 - UNDERCARRIAGE
 1-12 - REFER TO UNIT DIAGRAM 15 - VEHICLE NOT AT SCENE
 13 - TOP 99 - UNKNOWN

CONTRIBUTING CIRCUMSTANCES

1 - NONE 7 - LEFT OF CENTER 13 - IMPROPER START FROM A PARKED POSITION 17 - VISION OBSTRUCTION 21 - LYING IN ROADWAY
 2 - FAILURE TO YIELD 8 - FOLLOWING TOO CLOSE / ACDA 14 - OPERATING DEFECTIVE EQUIPMENT 18 - NOT DISCERNIBLE 22 - NOT DISCERNIBLE
 3 - RAN RED LIGHT 9 - IMPROPER LANE CHANGE 15 - STOPPED OR PARKED ILLEGALLY 19 - LOAD SHIFTING/FALLING/SPILLING 23 - OPENING DOOR INTO ROADWAY
 4 - RAN STOP SIGN 10 - IMPROPER PASSING 16 - SWERVING TO AVOID 20 - IMPROPER CROSSING 99 - OTHER IMPROPER ACTION
 5 - UNSAFE SPEED 11 - DROVE OFF ROAD 17 - WRONG WAY
 6 - IMPROPER TURN 12 - IMPROPER BACKING

TRAFFIC

TRAFFICWAY FLOW

2 1 - ONE-WAY
 2 - TWO-WAY

TRAFFIC CONTROL

6 1 - ROUNDABOUT 4 - STOP SIGN
 2 - SIGNAL 5 - YIELD SIGN
 3 - FLASHER 6 - NO CONTROL

SEQUENCE OF EVENTS

1 **09**

1 - OVERTURN/ROLLOVER 6 - EQUIPMENT FAILURE 11 - CROSS CENTERLINE - OPPOSITE DIRECTION OF TRAVEL 16 - RAILWAY VEHICLE
 2 - FIRE/EXPLOSION 7 - SEPARATION OF UNITS 12 - DOWNHILL RUNAWAY 17 - ANIMAL - FARM
 3 - IMMERSION 8 - RAN OFF ROAD RIGHT 13 - OTHER NON-COLLISION 18 - ANIMAL - DEER
 4 - JACKKNIFE 9 - RAN OFF ROAD LEFT 14 - PEDESTRIAN 19 - ANIMAL - OTHER
 5 - CARGO / EQUIPMENT LOSS OR SHIFT 10 - CROSS MEDIAN 15 - PEDALCYCLE 20 - MOTOR VEHICLE IN TRANSPORT
 21 - PARKED MOTOR VEHICLE

OF THROUGH LANES ON ROAD

1

RAIL GRADE CROSSING

1 1 - NOT INVOLVED
 2 - INVOLVED-ACTIVE CROSSING
 3 - INVOLVED-PASSIVE CROSSING

UNIT / NON-MOTORIST DIRECTION

FROM **3** TO **4**

1 - NORTH 5 - NORTHEAST
 2 - SOUTH 6 - NORTHWEST
 3 - EAST 7 - SOUTHEAST
 4 - WEST 8 - SOUTHWEST
 9 - OTHER / UNKNOWN

COLLISION WITH FIXED OBJECT - STRUCK

25 - IMPACT ATTENUATOR / CRASH CUSHION 31 - GUARDRAIL END 37 - TRAFFIC SIGN POST 43 - CURB 50 - WORK ZONE MAINTENANCE EQUIPMENT
 26 - BRIDGE OVERHEAD STRUCTURE 32 - PORTABLE BARRIER 38 - OVERHEAD SIGN POST 44 - DITCH 51 - WALL
 27 - BRIDGE PIER OR ABUTMENT 33 - MEDIAN CABLE BARRIER 39 - LIGHT / LUMINARIES SUPPORT 45 - EMBANKMENT 52 - BUILDING
 28 - BRIDGE PARAPET 34 - MEDIAN GUARDRAIL BARRIER 40 - UTILITY POLE 46 - FENCE 53 - TUNNEL
 29 - BRIDGE RAIL 35 - MEDIAN CONCRETE BARRIER 41 - OTHER POST, POLE OR SUPPORT 47 - MAILBOX 54 - OTHER FIXED OBJECT
 30 - GUARDRAIL FACE 36 - MEDIAN OTHER BARRIER 42 - CULVERT 48 - TREE 99 - OTHER / UNKNOWN
 49 - FIRE HYDRANT

1 FIRST HARMFUL EVENT **2** MOST HARMFUL EVENT

UNIT SPEED

25

POSTED SPEED

10

DETECTED SPEED

2 1 - STATED / ESTIMATED SPEED
 2 - CALCULATED / EDR
 3 - UNDETERMINED



MOTORIST / Non-MOTORIST

LOCAL REPORT NUMBER
2023-00005864

UNIT # 01	NAME: LAST, FIRST, MIDDLE Heinz, Linda L	DATE OF BIRTH 06181941		AGE 82	GENDER F
ADDRESS: STREET, CITY, STATE, ZIP 2451 Indian Wells TL Trail Xenia, OH 45385		CONTACT PHONE - INCLUDE AREA CODE			
INJURIES 3	INJURED TAKEN BY 2	EMS AGENCY (NAME) Bellbrook FD	INJURED TAKEN TO: MEDICAL FACILITY (NAME, CITY) MIAMI VALLEY SOUTH HEALTH	SAFETY EQUIPMENT USED DOT-COMPLIANT MC HELMET	SEATING POSITION 01
OL STATE	OPERATOR LICENSE NUMBER	OFFENSE CHARGED	LOCAL CODE	OFFENSE DESCRIPTION	CITATION NUMBER
OL CLASS	ENDORSEMENT SELECT UP TO 2	RESTRICTION SELECT UP TO 3	DRIVER DISTRACTED BY 1	ALCOHOL / DRUG SUSPECTED <input type="checkbox"/> ALCOHOL <input type="checkbox"/> MARIJUANA <input type="checkbox"/> OTHER DRUG	CONDITION 1
				ALCOHOL TEST STATUS: 1, TYPE: 1, VALUE: .	DRUG TEST(S) STATUS: 1, TYPE: 1, RESULT: SELECT UP TO 4

UNIT #	NAME: LAST, FIRST, MIDDLE	DATE OF BIRTH		AGE	GENDER
ADDRESS: STREET, CITY, STATE, ZIP		CONTACT PHONE - INCLUDE AREA CODE			
INJURIES	INJURED TAKEN BY	EMS AGENCY (NAME)	INJURED TAKEN TO: MEDICAL FACILITY (NAME, CITY)	SAFETY EQUIPMENT USED	SEATING POSITION
OL STATE	OPERATOR LICENSE NUMBER	OFFENSE CHARGED	LOCAL CODE	OFFENSE DESCRIPTION	CITATION NUMBER
OL CLASS	ENDORSEMENT SELECT UP TO 2	RESTRICTION SELECT UP TO 3	DRIVER DISTRACTED BY	ALCOHOL / DRUG SUSPECTED <input type="checkbox"/> ALCOHOL <input type="checkbox"/> MARIJUANA <input type="checkbox"/> OTHER DRUG	CONDITION
				ALCOHOL TEST STATUS: , TYPE: , VALUE: .	DRUG TEST(S) STATUS: , TYPE: , RESULT: SELECT UP TO 4

UNIT #	NAME: LAST, FIRST, MIDDLE	DATE OF BIRTH		AGE	GENDER
ADDRESS: STREET, CITY, STATE, ZIP		CONTACT PHONE - INCLUDE AREA CODE			
INJURIES	INJURED TAKEN BY	EMS AGENCY (NAME)	INJURED TAKEN TO: MEDICAL FACILITY (NAME, CITY)	SAFETY EQUIPMENT USED	SEATING POSITION
OL STATE	OPERATOR LICENSE NUMBER	OFFENSE CHARGED	LOCAL CODE	OFFENSE DESCRIPTION	CITATION NUMBER
OL CLASS	ENDORSEMENT SELECT UP TO 2	RESTRICTION SELECT UP TO 3	DRIVER DISTRACTED BY	ALCOHOL / DRUG SUSPECTED <input type="checkbox"/> ALCOHOL <input type="checkbox"/> MARIJUANA <input type="checkbox"/> OTHER DRUG	CONDITION
				ALCOHOL TEST STATUS: , TYPE: , VALUE: .	DRUG TEST(S) STATUS: , TYPE: , RESULT: SELECT UP TO 4

INJURIES	SEATING POSITION	AIR BAG	OL CLASS	OL RESTRICTION(S)	DRIVER DISTRACTION	TEST STATUS
1 - FATAL	1 - FRONT - LEFT SIDE (MOTORCYCLE DRIVER)	1 - NOT DEPLOYED	1 - CLASS A	1 - ALCOHOL INTERLOCK DEVICE	1 - NOT DISTRACTED	1 - NONE GIVEN
2 - SUSPECTED SERIOUS INJURY	2 - FRONT - MIDDLE	2 - DEPLOYED FRONT	2 - CLASS B	2 - CDL INTRASTATE ONLY	2 - MANUALLY OPERATING AN ELECTRONIC COMMUNICATION DEVICE (TEXTING, TYPING, DIALING)	2 - TEST REFUSED
3 - SUSPECTED MINOR INJURY	3 - FRONT - RIGHT SIDE	3 - DEPLOYED SIDE	3 - CLASS C	3 - CORRECTIVE LENSES	3 - TALKING ON HANDS-FREE COMMUNICATION DEVICE	3 - TEST GIVEN, CONTAMINATED SAMPLE / UNUSABLE
4 - POSSIBLE INJURY	4 - SECOND - LEFT SIDE (MOTORCYCLE PASSENGER)	4 - DEPLOYED BOTH FRONT / SIDE	4 - REGULAR CLASS (OHIO = D)	4 - FARM WAIVER	4 - TALKING ON HAND-HELD COMMUNICATION DEVICE	4 - TEST GIVEN, RESULTS KNOWN
5 - NO APPARENT INJURY	5 - SECOND - MIDDLE	5 - NOT APPLICABLE	5 - MC MOPED ONLY	5 - EXCEPT CLASS A BUS	5 - OTHER ACTIVITY WITH AN ELECTRONIC DEVICE	5 - TEST GIVEN, RESULTS UNKNOWN
INJURED TAKEN BY		EJECTION		ALCOHOL TEST TYPE		
1 - NOT TRANSPORTED / TREATED AT SCENE	6 - SECOND - RIGHT SIDE	1 - NOT EJECTED	H - HAZMAT	6 - EXCEPT CLASS A & CLASS B BUS	1 - NONE	
2 - EMS	7 - THIRD - LEFT SIDE (MOTORCYCLE SIDE CAR)	2 - PARTIALLY EJECTED	M - MOTORCYCLE	7 - EXCEPT TRACTOR-TRAILER	2 - BLOOD	
3 - POLICE	8 - THIRD - MIDDLE	3 - TOTALLY EJECTED	P - PASSENGER	8 - INTERMEDIATE LICENSE RESTRICTIONS	3 - URINE	
9 - OTHER / UNKNOWN	9 - THIRD - RIGHT SIDE	4 - NOT APPLICABLE	N - TANKER	9 - LEARNER'S PERMIT RESTRICTIONS	4 - BREATH	
SAFETY EQUIPMENT		TRAPPED		DRUG TEST TYPE		
1 - NONE USED	10 - SLEEPER SECTION OF TRUCK CAB	1 - NOT TRAPPED	Q - MOTOR SCOOTER	10 - LIMITED TO DAYLIGHT ONLY	1 - NONE	
2 - SHOULDER BELT ONLY USED	11 - PASSENGER IN OTHER ENCLOSED CARGO AREA (NON-TRAILING UNIT, BUS, PICK-UP WITH CAP)	2 - EXTRICATED BY MECHANICAL MEANS	R - THREE-WHEEL MOTORCYCLE	11 - LIMITED TO EMPLOYMENT	2 - BLOOD	
3 - LAP BELT ONLY USED	12 - PASSENGER IN UNENCLOSED CARGO AREA	3 - FREED BY NON-MECHANICAL MEANS	S - SCHOOL BUS	12 - LIMITED - OTHER	3 - URINE	
4 - SHOULDER & LAP BELT USED	13 - TRAILING UNIT		T - DOUBLE & TRIPLE TRAILERS	13 - MECHANICAL DEVICES (SPECIAL BRAKES, HAND CONTROLS, OR OTHER ADAPTIVE DEVICES)	4 - OTHER	
5 - CHILD RESTRAINT SYSTEM - FORWARD FACING	14 - RIDING ON VEHICLE EXTERIOR (NON-TRAILING UNIT)		X - TANKER / HAZMAT	14 - MILITARY VEHICLES ONLY		
6 - CHILD RESTRAINT SYSTEM - REAR FACING	15 - NON-MOTORIST			15 - MOTOR VEHICLES WITHOUT AIR BRAKES	DRUG TEST RESULT(S)	
7 - BOOSTER SEAT	99 - OTHER / UNKNOWN		GENDER	16 - OUTSIDE MIRROR	1 - AMPHETAMINES	
8 - HELMET USED			F - FEMALE	17 - PROSTHETIC AID	2 - BARBITURATES	
9 - PROTECTIVE PADS USED (ELBOW, KNEES, ETC.)			M - MALE	18 - OTHER	3 - BENZODIAZEPINES	
10 - REFLECTIVE CLOTHING			U - OTHER / UNKNOWN		4 - CANNABINOIDS	
11 - LIGHTING - PEDESTRIAN / BICYCLE ONLY					5 - COCAINE	
99 - OTHER / UNKNOWN					6 - OPIATES / OPIOIDS	
					7 - OTHER	
					8 - NEGATIVE RESULTS	



OCCUPANT / WITNESS ADDENDUM

LOCAL REPORT NUMBER
2023-00005864

OCCUPANT	UNIT # []	NAME: LAST, FIRST, MIDDLE			DATE OF BIRTH [] [] [] [] [] []		AGE []	GENDER []	
	ADDRESS: STREET, CITY, STATE, ZIP				CONTACT PHONE - INCLUDE AREA CODE [] [] [] [] [] [] [] [] [] []				
INJURIES []	INJURED TAKEN BY []	EMS AGENCY (NAME) []	INJURED TAKEN TO: MEDICAL FACILITY (NAME, CITY) []	SAFETY EQUIPMENT USED []	<input type="checkbox"/> DOT-COMPLIANT MC HELMET	SEATING POSITION []	AIR BAG USAGE []	EJECTION []	TRAPPED []

OCCUPANT	UNIT # []	NAME: LAST, FIRST, MIDDLE			DATE OF BIRTH [] [] [] [] [] []		AGE []	GENDER []	
	ADDRESS: STREET, CITY, STATE, ZIP				CONTACT PHONE - INCLUDE AREA CODE [] [] [] [] [] [] [] [] [] []				
INJURIES []	INJURED TAKEN BY []	EMS AGENCY (NAME) []	INJURED TAKEN TO: MEDICAL FACILITY (NAME, CITY) []	SAFETY EQUIPMENT USED []	<input type="checkbox"/> DOT-COMPLIANT MC HELMET	SEATING POSITION []	AIR BAG USAGE []	EJECTION []	TRAPPED []

OCCUPANT	UNIT # []	NAME: LAST, FIRST, MIDDLE			DATE OF BIRTH [] [] [] [] [] []		AGE []	GENDER []	
	ADDRESS: STREET, CITY, STATE, ZIP				CONTACT PHONE - INCLUDE AREA CODE [] [] [] [] [] [] [] [] [] []				
INJURIES []	INJURED TAKEN BY []	EMS AGENCY (NAME) []	INJURED TAKEN TO: MEDICAL FACILITY (NAME, CITY) []	SAFETY EQUIPMENT USED []	<input type="checkbox"/> DOT-COMPLIANT MC HELMET	SEATING POSITION []	AIR BAG USAGE []	EJECTION []	TRAPPED []

OCCUPANT	UNIT # []	NAME: LAST, FIRST, MIDDLE			DATE OF BIRTH [] [] [] [] [] []		AGE []	GENDER []	
	ADDRESS: STREET, CITY, STATE, ZIP				CONTACT PHONE - INCLUDE AREA CODE [] [] [] [] [] [] [] [] [] []				
INJURIES []	INJURED TAKEN BY []	EMS AGENCY (NAME) []	INJURED TAKEN TO: MEDICAL FACILITY (NAME, CITY) []	SAFETY EQUIPMENT USED []	<input type="checkbox"/> DOT-COMPLIANT MC HELMET	SEATING POSITION []	AIR BAG USAGE []	EJECTION []	TRAPPED []

INJURIES	SAFETY EQUIPMENT USED	SEATING POSITION	AIR BAG USAGE
1 - FATAL	1 - NONE USED - VEHICLE OCCUPANT	1 - FRONT - LEFT SIDE (MOTORCYCLE DRIVER)	1 - NOT DEPLOYED
2 - SUSPECTED SERIOUS INJURY	2 - SHOULDER BELT ONLY USED	2 - FRONT - MIDDLE	2 - DEPLOYED FRONT
3 - SUSPECTED MINOR INJURY	3 - LAP BELT ONLY USED	3 - FRONT - RIGHT SIDE	3 - DEPLOYED SIDE
4 - POSSIBLE INJURY	4 - SHOULDER & LAP BELT USED	4 - SECOND - LEFT SIDE (MOTORCYCLE PASSENGER)	4 - DEPLOYED BOTH FRONT/SIDE
5 - NO APPARENT INJURY	5 - CHILD RESTRAINT SYSTEM - FORWARD FACING	5 - SECOND - MIDDLE	5 - NOT APPLICABLE
INJURED TAKEN BY			
1 - NOT TRANSPORTED / TREATED AT SCENE	6 - CHILD RESTRAINT SYSTEM - REAR FACING	6 - SECOND - RIGHT SIDE	9 - DEPLOYMENT UNKNOWN
2 - EMS	7 - BOOSTER SEAT	7 - THIRD - LEFT SIDE (MOTORCYCLE SIDE CAR)	EJECTION
3 - POLICE	8 - HELMET USED	8 - THIRD - MIDDLE	1 - NOT EJECTED
9 - OTHER / UNKNOWN	9 - PROTECTIVE PADS USED (ELBOW, KNEES, ETC.)	9 - THIRD - RIGHT SIDE	2 - PARTIALLY EJECTED
GENDER			
F - FEMALE	10 - REFLECTIVE CLOTHING	10 - SLEEPER SECTION OF TRUCK CAB	3 - TOTALLY EJECTED
M - MALE	11 - LIGHTING - PEDESTRIAN / BICYCLE ONLY	11 - PASSENGER IN OTHER ENCLOSED CARGO AREA (NON-TRAILING UNIT, BUS, PICK-UP WITH CAP)	4 - NOT APPLICABLE
U - OTHER / UNKNOWN	99 - OTHER / UNKNOWN	12 - PASSENGER IN UNENCLOSED CARGO AREA	TRAPPED
		13 - TRAILING UNIT	1 - NOT TRAPPED
		14 - RIDING ON VEHICLE EXTERIOR (NON-TRAILING UNIT)	2 - EXTRICATED BY MECHANICAL MEANS
		15 - NON-MOTORIST	3 - FREED BY NON-MECHANICAL MEANS
		99 - OTHER / UNKNOWN	

WITNESS	NAME: LAST, FIRST, MIDDLE Ferrin, Michael J	DATE OF BIRTH 08201976		AGE 47	GENDER M
	ADDRESS: STREET, CITY, STATE, ZIP 3881 Upper Bellbrook RD Road Bellbrook, OH 45305			CONTACT PHONE - INCLUDE AREA CODE 9376207334	

WITNESS	NAME: LAST, FIRST, MIDDLE	DATE OF BIRTH		AGE	GENDER
	ADDRESS: STREET, CITY, STATE, ZIP			CONTACT PHONE - INCLUDE AREA CODE	

WITNESS	NAME: LAST, FIRST, MIDDLE	DATE OF BIRTH		AGE	GENDER
	ADDRESS: STREET, CITY, STATE, ZIP			CONTACT PHONE - INCLUDE AREA CODE	

OHIO TRAFFIC ACCIDENT – DIAGRAM/NARRATIVE CONTINUATION

OH-2 (Rev. 1/82)

LOCAL REPORT NUMBER 2023-00005864	REPORTING AGENCY Bellbrook Police	DATE OF ACCIDENT M 12 D 08 Y 2023
IN COUNTY OF 29 Greene	ACCIDENT LOCATION 3869 Upper Bellbrook RD Road	

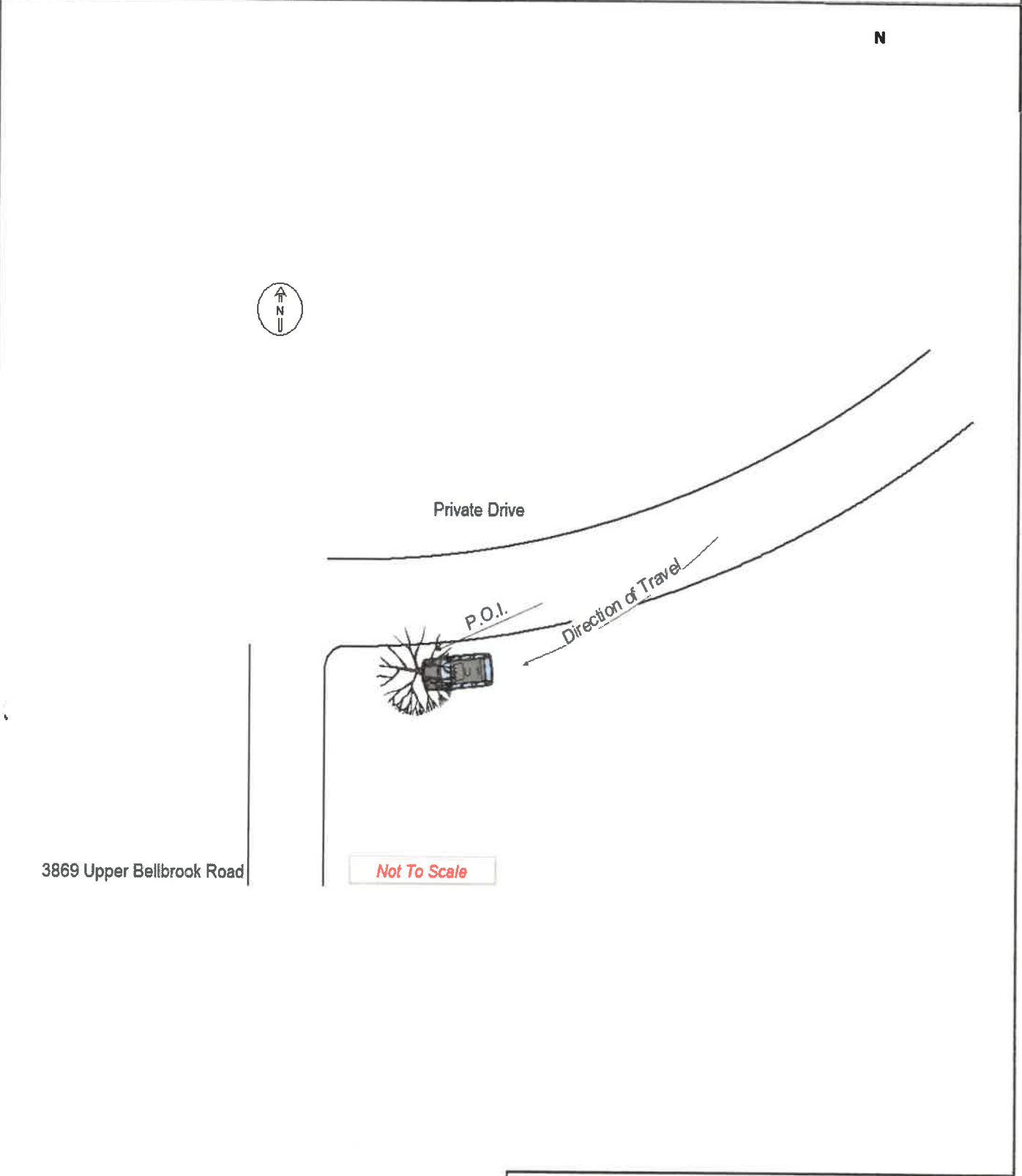

OFFICERS SIGNATURE BB42 Williams, Greg, M,	BADGE NO BB42
--	-------------------------



LOCAL REPORT NUMBER 23-58064	REPORTING AGENCY Bellbrook P.D.	DATE OF CRASH M 12 D 8 Y 2023
---------------------------------	------------------------------------	----------------------------------

FOR LOCAL USE ONLY - DO NOT SUBMIT TO THE STATE EXCEPT FOR FATAL CRASHES

I, MIKE FERRIN HEREBY MAKE THIS VOLUNTARY STATEMENT TO
PRINTED

G. Williams AT 3869 UPPER BELLBROOK RD
OFFICER'S NAME LOCATION

I HEARD CAR CAR ENGINE START AND SAW HEADLIGHTS THAT WAS COMING DOWN THE DRIVEWAY.
 I HEARD THE ENGINE REV AND SAW THE VEHICLE COME DOWN THE DRIVEWAY AND COULDN'T MAKE
 THE TURN ONTO THE LANE. THE CAR TRIED TO MAKE THE RIGHT TURN BUT
 THE CAR'S LEFT SIDE TIRES DROPPED OFF OF THE ROAD AND THE DRIVER LOST
 CONTROL AND STRUCK A LARGE TREE NEAR BY. I APPROACHED THE VEHICLE AND ALL
 AIR BAGS WERE DEPLOYED. THE DRIVER WAS AWAKE AND ALERT. I WENT TO THE
 DRIVER SIDE OF THE CAR AND OPENED THE DOOR. I STABILIZED THE DRIVER THAT
 WAS TRYING TO GET OUT UNTIL THE FAMILY AND EMERGENCY SERVICES ARRIVED.

[REDACTED]

ADDRESS OF WITNESS
3869 UPPER BELLBROOK RD, BELLBROOK, OH 45305

SIGNATURE OF WITNESS [Signature] 7334 957-620
 OFFICER'S SIGNATURE [Signature] X