

TRAFFIC CRASH REPORT

*DENOTES MANDATORY FIELD FOR SUPPLEMENT REPORT

LOCAL REPORT NUMBER*

2024-00005682

PHOTOS TAKEN
 SECONDARY CRASH
 PRIVATE PROPERTY

OH-2
 OH-1P
 OTHER

LOCAL INFORMATION

REPORTING AGENCY NAME*
Bellbrook Police

NCIC*
02905

HIT/SKIP
1 - SOLVED
2 - UNSOLVED

NUMBER OF UNITS
01

UNIT IN ERROR
98 - ANIMAL
99 - UNKNOWN

2 **01** **01**

COUNTY* **29** LOCALITY* **1** LOCATION: CITY, VILLAGE, TOWNSHIP*
Bellbrook

CRASH DATE / TIME*
07012024 2103

CRASH SEVERITY
1 - FATAL
2 - SERIOUS INJURY SUSPECTED
3 - MINOR INJURY SUSPECTED
4 - INJURY POSSIBLE
5 - PROPERTY DAMAGE ONLY

5

ROUTE TYPE ROUTE NUMBER PREFIX LOCATION ROAD NAME ROAD TYPE

1 **1** **1** **WILMINGTON DAYTON** **R D**

LATITUDE DECIMAL DEGREES
39.633108

ROUTE TYPE ROUTE NUMBER PREFIX REFERENCE ROAD NAME (ROAD, MILEPOST, HOUSE #) ROAD TYPE

1 **1** **1** **7280** **R D**

LONGITUDE DECIMAL DEGREES
-84.110501

REFERENCE POINT
1 - INTERSECTION
2 - MILE POST
3 - HOUSE #

DIRECTION FROM REFERENCE
1 - NORTH
2 - SOUTH
3 - EAST
4 - WEST

ROUTE TYPE
IR - INTERSTATE ROUTE (TP)
US - FEDERAL US ROUTE
SR - STATE ROUTE
CR - NUMBERED COUNTY ROUTE
TR - NUMBERED TOWNSHIP ROUTE

ROAD TYPE
AL - ALLEY
AV - AVENUE
BL - BOULEVARD
CR - CIRCLE
CT - COURT
DR - DRIVE
HE - HEIGHTS

HW - HIGHWAY
LA - LANE
MP - MILEPOST
OV - OVAL
PK - PARKWAY
PI - PIKE
PL - PLACE

RD - ROAD
SQ - SQUARE
ST - STREET
TE - TERRACE
TL - TRAIL
WA - WAY

DISTANCE FROM REFERENCE
25

DISTANCE UNIT OF MEASURE
1 - MILES
2 - FEET
3 - YARDS
2

INTERSECTION RELATED

WITHIN INTERSECTION OR ON APPROACH

WITHIN INTERCHANGE AREA

NUMBER OF APPROACHES

ROADWAY

ROADWAY DIVIDED

LOCATION OF FIRST HARMFUL EVENT

1 - ON ROADWAY
2 - ON SHOULDER
3 - IN MEDIAN
4 - ON ROADSIDE
5 - ON GORE
6 - OUTSIDE TRAFFIC WAY
7 - ON RAMP
8 - OFF RAMP

9 - CROSSOVER
10 - DRIVEWAY/ALLEY ACCESS
11 - RAILWAY GRADE CROSSING
12 - SHARED USE PATHS OR TRAILS
13 - BIKE LANE
14 - TOLL BOOTH
99 - OTHER / UNKNOWN

04

MANNER OF CRASH COLLISION/IMPACT

1 - NOT COLLISION BETWEEN TWO MOTOR VEHICLES IN TRANSPORT
2 - REAR-END
3 - HEAD-ON
4 - REAR-TO-REAR
5 - BACKING
6 - ANGLE
7 - SIDESWIPE, SAME DIRECTION
8 - SIDESWIPE, OPPOSITE DIRECTION
9 - OTHER / UNKNOWN

1

DIRECTION OF TRAVEL

1 - NORTH
2 - SOUTH
3 - EAST
4 - WEST

MEDIAN TYPE

1 - DIVIDED FLUSH MEDIAN (<4 FEET)
2 - DIVIDED FLUSH MEDIAN (≥4 FEET)
3 - DIVIDED, DEPRESSED MEDIAN
4 - DIVIDED, RAISED MEDIAN (ANY TYPE)
9 - OTHER/UNKNOWN

WORK ZONE RELATED
 WORKERS PRESENT
 LAW ENFORCEMENT PRESENT
 ACTIVE SCHOOL ZONE

WORK ZONE TYPE

1 - LANE CLOSURE
2 - LANE SHIFT/CROSSOVER
3 - WORK ON SHOULDER OR MEDIAN
4 - INTERMITTENT OR MOVING WORK
5 - OTHER

5

LOCATION OF CRASH IN WORK ZONE

1 - BEFORE THE 1ST WORK ZONE WARNING SIGN
2 - ADVANCE WARNING AREA
3 - TRANSITION AREA
4 - ACTIVITY AREA
5 - TERMINATION AREA

4

CONTOUR

1 - STRAIGHT LEVEL
2 - STRAIGHT GRADE
3 - CURVE LEVEL
4 - CURVE GRADE
9 - OTHER/UNKNOWN

1

CONDITIONS

1 - DRY
2 - WET
3 - SNOW
4 - ICE
5 - SAND, MUD, DIRT, OIL, GRAVEL
6 - WATER (STANDING, MOVING)
7 - SLUSH
9 - OTHER/UNKNOWN

9

SURFACE

1 - CONCRETE
2 - BLACKTOP, BITUMINOUS, ASPHALT
3 - BRICK/BLOCK
4 - SLAG, GRAVEL, STONE
5 - DIRT
9 - OTHER/UNKNOWN

2

LIGHT CONDITION

1 - DAYLIGHT
2 - DAWN/DUSK
3 - DARK - LIGHTED ROADWAY
4 - DARK - ROADWAY NOT LIGHTED
5 - DARK - UNKNOWN ROADWAY LIGHTING
9 - OTHER / UNKNOWN

9

WEATHER

1 - CLEAR
2 - CLOUDY
3 - FOG, SMOG, SMOKE
4 - RAIN
5 - SLEET, HAIL
6 - SNOW
7 - SEVERE CROSSWINDS
8 - BLOWING SAND, SOIL, DIRT, SNOW
9 - FREEZING RAIN OR FREEZING DRIZZLE
99 - OTHER / UNKNOWN

99

NARRATIVE

Unknown Unit 1 was traveling southbound on Wilmington Dayton Rd near the address of 7280 Wilmington Dayton Rd prior to entering and inactive construction zone, drove off the roadway, striking a Downhill Grade street sign. Unit 1 was not present at the scene of the crash.

Damage to the post has an approximate cost of \$100.

See OH2

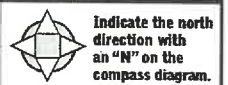

CRASH REPORTED DATE / TIME: **07012024 2103**

DISPATCH DATE / TIME: **07012024 2016**

ARRIVAL DATE / TIME: **07012024 2042**

SCENE CLEARED DATE / TIME: **07012024 2115**

REPORT TAKEN BY

POLICE AGENCY
 MOTORIST

SUPPLEMENT (CORRECTION OR ADDITION TO AN EXISTING REPORT SENT TO HQS)

TOTAL TIME ROADWAY CLOSED: **0**

OTHER INVESTIGATION TIME: **60**

TOTAL MINUTES: **119**

OFFICER'S NAME*
Moore

CHECKED BY OFFICER'S NAME*
Williams

OFFICER'S BADGE NUMBER*
B B 5 0

CHECKED BY OFFICER'S BADGE NUMBER*
B B 4 2

OWNER

UNIT # 01 OWNER NAME: LAST, FIRST, MIDDLE SAME AS DRIVER) **UNKNOWN,** OWNER PHONE: INCLUDE AREA CODE SAME AS DRIVER)

OWNER ADDRESS: STREET, CITY, STATE, ZIP SAME AS DRIVER)

COMMERCIAL CARRIER: NAME, ADDRESS, CITY, STATE, ZIP COMMERCIAL CARRIER PHONE: INCLUDE AREA CODE

DAMAGE

DAMAGE SCALE

9 1 - NONE 3 - FUNCTIONAL DAMAGE
2 - MINOR DAMAGE 4 - DISABLING DAMAGE
9 - UNKNOWN

VEHICLE

LP STATE _____ LICENSE PLATE # _____ VEHICLE IDENTIFICATION # _____ VEHICLE YEAR _____ VEHICLE MAKE _____

INSURANCE VERIFIED INSURANCE COMPANY _____ INSURANCE POLICY # _____ COLOR _____ VEHICLE MODEL _____

COMMERCIAL GOVERNMENT IN EMERGENCY RESPONSE

INTERLOCK DEVICE EQUIPPED HIT/SKIP UNIT #OCCUPANTS _____

US DOT # _____ TOWED BY: COMPANY NAME _____

HAZARDOUS MATERIAL
 MATERIAL RELEASED CLASS # _____ PLACARD ID # _____
 PLACARD _____

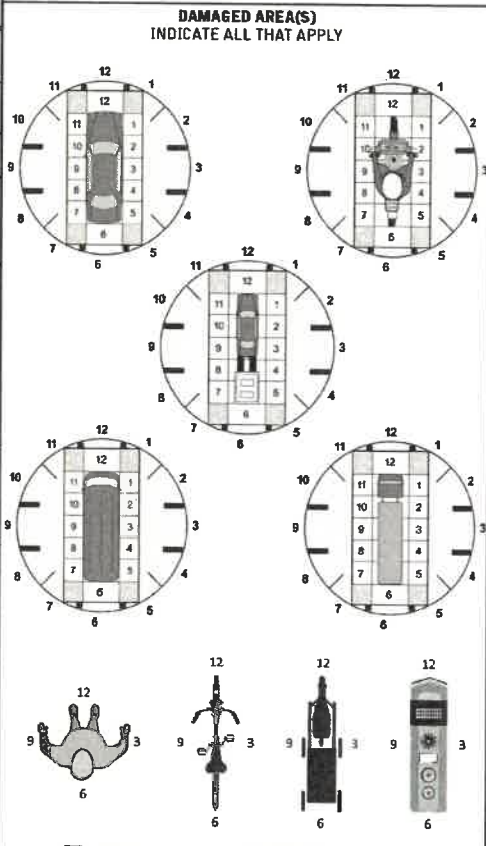

VEHICLE TYPE

99

1 - PASSENGER CAR 7 - MOTORCYCLE 2-WHEELED 12 - GOLF CART 18 - LIMO (LIVERY VEHICLE) 23 - PEDESTRIAN / SKATER
2 - PASSENGER VAN (MINIVAN) 8 - MOTORCYCLE 3-WHEELED 13 - SNOWMOBILE 19 - BUS (16+ PASSENGERS) 24 - WHEELCHAIR (ANY TYPE)
3 - SPORT UTILITY VEHICLE 9 - AUTOCYCLE 14 - SINGLE UNIT TRUCK 20 - OTHER VEHICLE 25 - OTHER NON-MOTORIST
4 - PICK UP 10 - MOPED OR MOTORIZED BICYCLE 15 - SEMI-TRACTOR 21 - HEAVY EQUIPMENT 26 - BICYCLE
5 - CARGO VAN 11 - ALL TERRAIN VEHICLE (ATV/UTV) 16 - FARM EQUIPMENT 22 - ANIMAL WITH RIDER OR ANIMAL-DRAWN VEHICLE 27 - TRAIN
6 - VAN (9-15 SEATS) 17 - MOTORHOME 99 - UNKNOWN OR HIT/SKIP

OF TRAILING UNITS _____

SPECIAL FUNCTION

WAS VEHICLE OPERATING IN AUTONOMOUS MODE WHEN CRASH OCCURRED? 1-YES 2-NO 9-OTHER/UNKNOWN

AUTONOMOUS MODE LEVEL

0 - NO AUTOMATION 3 - CONDITIONAL AUTOMATION 9 - UNKNOWN
1 - DRIVER ASSISTANCE 4 - HIGH AUTOMATION
2 - PARTIAL AUTOMATION 5 - FULL AUTOMATION

1 - NONE 6 - BUS - CHARTER/TOUR 11 - FIRE 16 - FARM 21 - MAIL CARRIER
2 - TAXI 7 - BUS - INTERCITY 12 - MILITARY 17 - MOWING 19 - OTHER/UNKNOWN
3 - ELECTRONIC RIDE SHARING 8 - BUS - SHUTTLE 13 - POLICE 18 - SNOW REMOVAL
4 - SCHOOL TRANSPORT 9 - BUS - OTHER 14 - PUBLIC UTILITY 19 - TOWING
5 - BUS - TRANSIT/COMMUTER 10 - AMBULANCE 15 - CONSTRUCTION EQUIPMENT 20 - SAFETY SERVICE PATROL

CARGO BODY TYPE

1 - NO CARGO BODY TYPE / NOT APPLICABLE 3 - VEHICLE TOWING ANOTHER MOTOR VEHICLE 5 - INTERMODAL CONTAINER CHASSIS 8 - POLE 12 - CONCRETE MIXER
2 - BUS 4 - LOGGING 6 - CARGO VAN/ENCLOSED BOX 10 - FLAT BED 13 - AUTOTRANSPORTER
7 - GRAIN/CHIPS/GRAVEL 11 - DUMP 14 - GARBAGE/REFUSE 99 - OTHER/UNKNOWN

VEHICLE DEFECTS

1 - TURN SIGNALS 4 - BRAKES 7 - WORN OR SLICK TIRES 9 - MOTOR TROUBLE 99 - OTHER/UNKNOWN
2 - HEAD LAMPS 5 - STEERING 8 - TRAILER EQUIPMENT DEFECTIVE 10 - DISABLED FROM PRIOR ACCIDENT
3 - TAIL LAMPS 6 - TIRE BLOWOUT

NON-MOTORIST LOCATION AT IMPACT

1 - INTERSECTION - MARKED CROSSWALK 3 - INTERSECTION - OTHER 6 - BICYCLE LANE 9 - MEDIUM CROSSING ISLAND 12 - FIRST RESPONDER AT INCIDENT SCENE
2 - INTERSECTION - UNMARKED CROSSWALK 4 - MIDBLOCK - MARKED CROSSWALK 7 - SHOULDER / ROADSIDE 10 - DRIVEWAY ACCESS 19 - OTHER/UNKNOWN
5 - TRAVEL LANE - OTHER LOCATION 8 - SIDEWALK 11 - SHARED USE PATHS OR TRAILS

ACTION

3 1 - NON-CONTACT 1 - STRAIGHT AHEAD 7 - MAKING U-TURN 13 - NEGOTIATING A CURVE 18 - APPROACHING OR LEAVING VEHICLE
2 - NON-COLLISION 2 - BACKING 8 - ENTERING TRAFFIC LANE 14 - ENTERING OR CROSSING SPECIFIED LOCATION 19 - STANDING
3 - STRIKING 01 3 - CHANGING LANES 9 - LEAVING TRAFFIC LANE 15 - WALKING, RUNNING, JOGGING, PLAYING 20 - OTHER NON-MOTORIST
4 - STRUCK PRE-CRASH ACTIONS 4 - OVERTAKING/PASSING 10 - PARKED 16 - WORKING 21 - STANDING OUTSIDE DISABLED VEHICLE
5 - BOTH STRIKING & STRUCK 5 - MAKING RIGHT TURN 11 - SLOWING OR STOPPED IN TRAFFIC 17 - PUSHING VEHICLE 99 - OTHER/UNKNOWN
9 - OTHER/UNKNOWN 6 - MAKING LEFT TURN 12 - DRIVERLESS

INITIAL POINT OF CONTACT

99 0 - NO DAMAGE 14 - UNDERCARRIAGE
1-12 - REFER TO UNIT DIAGRAM 15 - VEHICLE NOT AT SCENE
13 - TOP 99 - UNKNOWN

CONTRIBUTING CIRCUMSTANCES

11

1 - NONE 7 - LEFT OF CENTER 13 - IMPROPER START FROM A PARKED POSITION 17 - VISION OBSTRUCTION 21 - LYING IN ROADWAY
2 - FAILURE TO YIELD 8 - FOLLOWING TOO CLOSE / AQDA 14 - STOPPED OR PARKED ILLEGALLY 18 - OPERATING DEFECTIVE EQUIPMENT 22 - NOT DISCERNIBLE
3 - RAN RED LIGHT 9 - IMPROPER LANE CHANGE 15 - SWERVING TO AVOID 19 - LOAD SHIFTING/FALLING/SPILLING 23 - OPENING DOOR INTO ROADWAY
4 - RAN STOP SIGN 10 - IMPROPER PASSING 16 - WRONG WAY 20 - IMPROPER CROSSING 99 - OTHER IMPROPER ACTION
5 - UNSAFE SPEED 11 - DROVE OFF ROAD 17 - VISION OBSTRUCTION 21 - LYING IN ROADWAY
6 - IMPROPER TURN 12 - IMPROPER BACKING

TRAFFIC

TRAFFICWAY FLOW

2 1 - ONE-WAY
2 - TWO-WAY

TRAFFIC CONTROL

6 1 - ROUNDABOUT 4 - STOP SIGN
2 - SIGNAL 5 - YIELD SIGN
3 - FLASHER 6 - NO CONTROL

SEQUENCE OF EVENTS

08 1 - OVERTURN/ROLLOVER 6 - EQUIPMENT FAILURE 11 - CROSS CENTERLINE - OPPOSITE DIRECTION OF TRAVEL 16 - RAILWAY VEHICLE 22 - WORK ZONE MAINTENANCE EQUIPMENT
2 - FIRE/EXPLOSION 7 - SEPARATION OF UNITS 12 - DOWNHILL RUNAWAY 17 - ANIMAL - FARM 23 - STRUCK BY FALLING, SHIFTING CARGO OR ANYTHING SET IN MOTION BY A MOTOR VEHICLE
3 - IMMERSTION 8 - RAN OFF ROAD RIGHT 13 - OTHER NON-COLLISION 18 - ANIMAL - DEER 24 - OTHER MOVABLE OBJECT
4 - JACKKNIFE 9 - RAN OFF ROAD LEFT 14 - PEDESTRIAN 19 - ANIMAL - OTHER 20 - MOTOR VEHICLE IN TRANSPORT
5 - CARGO / EQUIPMENT LOSS OR SHIFT 10 - CROSS MEDIAN 15 - PEDALCYCLE 21 - PARKED MOTOR VEHICLE

OF THROUGH LANES ON ROAD

2

RAIL GRADE CROSSING

1 1 - NOT INVOLVED
2 - INVOLVED-ACTIVE CROSSING
3 - INVOLVED-PASSIVE CROSSING

COLLISION WITH FIXED OBJECT - STRUCK

25 - IMPACT ATTENUATOR / CRASH CUSHION 31 - GUARDRAIL END 37 - TRAFFIC SIGN POST 43 - CURB 50 - WORK ZONE MAINTENANCE EQUIPMENT
26 - BRIDGE OVERHEAD STRUCTURE 32 - PORTABLE BARRIER 38 - OVERHEAD SIGN POST 44 - DITCH 51 - WALL
27 - BRIDGE PIER OR ABUTMENT 33 - MEDIAN CABLE BARRIER 39 - LIGHT / LUMINARIES SUPPORT 45 - EMBANKMENT 52 - BUILDING
28 - BRIDGE PARAPET 34 - MEDIAN GUARDRAIL BARRIER 40 - UTILITY POLE 46 - FENCE 53 - TUNNEL
29 - BRIDGE RAIL 35 - MEDIAN CONCRETE BARRIER 41 - OTHER POST, POLE OR SUPPORT 47 - MAILBOX 54 - OTHER FIXED OBJECT
30 - GUARDRAIL FACE 36 - MEDIAN OTHER BARRIER 42 - CULVERT 48 - TREE 99 - OTHER / UNKNOWN
49 - FIRE HYDRANT

FIRST HARMFUL EVENT 1 **MOST HARMFUL EVENT** 2

UNIT / NON-MOTORIST DIRECTION

FROM 1 TO 2

1 - NORTH 5 - NORTHEAST
2 - SOUTH 6 - NORTHWEST
3 - EAST 7 - SOUTHEAST
4 - WEST 8 - SOUTHWEST
9 - OTHER/UNKNOWN

UNIT SPEED

DETECTED SPEED

3 1 - STATED / ESTIMATED SPEED
2 - CALCULATED / EDR
3 - UNDETERMINED

POSTED SPEED

3 5



MOTORIST / Non-MOTORIST

LOCAL REPORT NUMBER
2024-0005682

UNIT # 01	NAME: LAST, FIRST, MIDDLE UNKNOWN,		DATE OF BIRTH		AGE	GENDER				
ADDRESS: STREET, CITY, STATE, ZIP			CONTACT PHONE - INCLUDE AREA CODE							
INJURIES 5	INJURED TAKEN BY	EMS AGENCY (NAME)	INJURED TAKEN TO: MEDICAL FACILITY (NAME, CITY)	SAFETY EQUIPMENT USED 9 9	<input type="checkbox"/> DOT-COMPLIANT MC HELMET	SEATING POSITION 9 9	AIR BAG USAGE 6	EJECTION 1	TRAPPED 1	
OL STATE	OPERATOR LICENSE NUMBER	OFFENSE CHARGED		LOCAL CODE <input type="checkbox"/>	OFFENSE DESCRIPTION		CITATION NUMBER			
OL CLASS	ENDORSEMENT SELECT UP TO 2	RESTRICTION SELECT UP TO 3	DRIVER DISTRACTED BY 9	ALCOHOL / DRUG SUSPECTED <input type="checkbox"/> ALCOHOL <input type="checkbox"/> MARIJUANA <input type="checkbox"/> OTHER DRUG		CONDITION 9	ALCOHOL TEST STATUS TYPE VALUE		DRUG TEST(S) STATUS TYPE RESULT SELECT UP TO 4	

UNIT #	NAME: LAST, FIRST, MIDDLE		DATE OF BIRTH		AGE	GENDER				
ADDRESS: STREET, CITY, STATE, ZIP			CONTACT PHONE - INCLUDE AREA CODE							
INJURIES	INJURED TAKEN BY	EMS AGENCY (NAME)	INJURED TAKEN TO: MEDICAL FACILITY (NAME, CITY)	SAFETY EQUIPMENT USED	<input type="checkbox"/> DOT-COMPLIANT MC HELMET	SEATING POSITION	AIR BAG USAGE	EJECTION	TRAPPED	
OL STATE	OPERATOR LICENSE NUMBER	OFFENSE CHARGED		LOCAL CODE <input type="checkbox"/>	OFFENSE DESCRIPTION		CITATION NUMBER			
OL CLASS	ENDORSEMENT SELECT UP TO 2	RESTRICTION SELECT UP TO 3	DRIVER DISTRACTED BY	ALCOHOL / DRUG SUSPECTED <input type="checkbox"/> ALCOHOL <input type="checkbox"/> MARIJUANA <input type="checkbox"/> OTHER DRUG		CONDITION	ALCOHOL TEST STATUS TYPE VALUE		DRUG TEST(S) STATUS TYPE RESULT SELECT UP TO 4	

UNIT #	NAME: LAST, FIRST, MIDDLE		DATE OF BIRTH		AGE	GENDER				
ADDRESS: STREET, CITY, STATE, ZIP			CONTACT PHONE - INCLUDE AREA CODE							
INJURIES	INJURED TAKEN BY	EMS AGENCY (NAME)	INJURED TAKEN TO: MEDICAL FACILITY (NAME, CITY)	SAFETY EQUIPMENT USED	<input type="checkbox"/> DOT-COMPLIANT MC HELMET	SEATING POSITION	AIR BAG USAGE	EJECTION	TRAPPED	
OL STATE	OPERATOR LICENSE NUMBER	OFFENSE CHARGED		LOCAL CODE <input type="checkbox"/>	OFFENSE DESCRIPTION		CITATION NUMBER			
OL CLASS	ENDORSEMENT SELECT UP TO 2	RESTRICTION SELECT UP TO 3	DRIVER DISTRACTED BY	ALCOHOL / DRUG SUSPECTED <input type="checkbox"/> ALCOHOL <input type="checkbox"/> MARIJUANA <input type="checkbox"/> OTHER DRUG		CONDITION	ALCOHOL TEST STATUS TYPE VALUE		DRUG TEST(S) STATUS TYPE RESULT SELECT UP TO 4	

INJURIES	SEATING POSITION	AIR BAG	OL CLASS	OL RESTRICTION(S)	DRIVER DISTRACTION	TEST STATUS
1 - FATAL	1 - FRONT - LEFT SIDE (MOTORCYCLE DRIVER)	1 - NOT DEPLOYED	1 - CLASS A	1 - ALCOHOL INTERLOCK DEVICE	1 - NOT DISTRACTED	1 - NONE GIVEN
2 - SUSPECTED SERIOUS INJURY	2 - FRONT - MIDDLE	2 - DEPLOYED FRONT	2 - CLASS B	2 - CDL INTRASTATE ONLY	2 - MANUALLY OPERATING AN ELECTRONIC COMMUNICATION DEVICE (TEXTING, TYPING, DIALING)	2 - TEST REFUSED
3 - SUSPECTED MINOR INJURY	3 - FRONT - RIGHT SIDE	3 - DEPLOYED SIDE	3 - CLASS C	3 - CORRECTIVE LENSES	3 - TALKING ON HANDS-FREE COMMUNICATION DEVICE	3 - TEST GIVEN, CONTAMINATED SAMPLE / UNUSABLE
4 - POSSIBLE INJURY	4 - SECOND - LEFT SIDE (MOTORCYCLE PASSENGER)	4 - DEPLOYED BOTH FRONT / SIDE	4 - REGULAR CLASS (OHIO = D)	4 - FARM WAIVER	4 - TALKING ON HAND-HELD COMMUNICATION DEVICE	4 - TEST GIVEN, RESULTS KNOWN
5 - NO APPARENT INJURY	5 - SECOND - MIDDLE	5 - NOT APPLICABLE	5 - MC MOPED ONLY	5 - EXCEPT CLASS A BUS	5 - OTHER ACTIVITY WITH AN ELECTRONIC DEVICE	5 - TEST GIVEN, RESULTS UNKNOWN
INJURED TAKEN BY	6 - SECOND - RIGHT SIDE	9 - DEPLOYMENT UNKNOWN	6 - NO VALID OL	6 - EXCEPT CLASS A & CLASS B BUS	6 - PASSENGER	ALCOHOL TEST TYPE
1 - NOT TRANSPORTED / TREATED AT SCENE	7 - THIRD - LEFT SIDE (MOTORCYCLE SIDE CAR)	EJECTION	OL ENDORSEMENT	7 - EXCEPT TRACTOR-TRAILER	7 - OTHER DISTRACTION INSIDE THE VEHICLE	1 - NONE
2 - EMS	8 - THIRD - MIDDLE	1 - NOT EJECTED	H - HAZMAT	8 - INTERMEDIATE LICENSE RESTRICTIONS	8 - OTHER DISTRACTION OUTSIDE THE VEHICLE	2 - BLOOD
3 - POLICE	9 - THIRD - RIGHT SIDE	2 - PARTIALLY EJECTED	M - MOTORCYCLE	9 - LEARNER'S PERMIT RESTRICTIONS	9 - OTHER / UNKNOWN	3 - URINE
9 - OTHER / UNKNOWN	10 - SLEEPER SECTION OF TRUCK CAB	3 - TOTALLY EJECTED	P - PASSENGER	10 - LIMITED TO DAYLIGHT ONLY	CONDITION	4 - BREATH
SAFETY EQUIPMENT	11 - PASSENGER IN OTHER ENCLOSED CARGO AREA (NON-TRAILING UNIT, BUS, PICK-UP WITH CAP)	4 - NOT APPLICABLE	N - TANKER	11 - LIMITED TO EMPLOYMENT	1 - APPARENTLY NORMAL	5 - OTHER
1 - NONE USED	12 - PASSENGER IN UNENCLOSED CARGO AREA	TRAPPED	Q - MOTOR SCOOTER	12 - LIMITED - OTHER	2 - PHYSICAL IMPAIRMENT	DRUG TEST TYPE
2 - SHOULDER BELT ONLY USED	13 - TRAILING UNIT	1 - NOT TRAPPED	R - THREE-WHEEL MOTORCYCLE	13 - MECHANICAL DEVICES (SPECIAL BRAKES, HAND CONTROLS, OR OTHER ADAPTIVE DEVICES)	3 - EMOTIONAL (E.G., DEPRESSED, ANGRY, DISTURBED)	1 - NONE
3 - LAP BELT ONLY USED	14 - RIDING ON VEHICLE EXTERIOR (NON-TRAILING UNIT)	2 - EXTRICATED BY MECHANICAL MEANS	S - SCHOOL BUS	14 - MILITARY VEHICLES ONLY	4 - ILLNESS	2 - BLOOD
4 - SHOULDER & LAP BELT USED	15 - NON-MOTORIST	3 - FREED BY NON-MECHANICAL MEANS	T - DOUBLE & TRIPLE TRAILERS	15 - MOTOR VEHICLES WITHOUT AIR BRAKES	5 - FELL ASLEEP, FAINTED, FATIGUED, ETC.	3 - URINE
5 - CHILD RESTRAINT SYSTEM - FORWARD FACING	99 - OTHER / UNKNOWN		X - TANKER / HAZMAT	16 - OUTSIDE MIRROR	6 - UNDER THE INFLUENCE OF MEDICATIONS / DRUGS / ALCOHOL	4 - OTHER
6 - CHILD RESTRAINT SYSTEM - REAR FACING			GENDER	17 - PROSTHETIC AID	9 - OTHER / UNKNOWN	DRUG TEST RESULT(S)
7 - BOOSTER SEAT			F - FEMALE	18 - OTHER		1 - AMPHETAMINES
8 - HELMET USED			M - MALE			2 - BARBITURATES
9 - PROTECTIVE PADS USED (ELBOW, KNEES, ETC.)			U - OTHER / UNKNOWN			3 - BENZODIAZEPINES
10 - REFLECTIVE CLOTHING						4 - CANNABINOIDS
11 - LIGHTING - PEDESTRIAN / BICYCLE ONLY						5 - COCAINE
99 - OTHER / UNKNOWN						6 - OPIATES / OPIOIDS
						7 - OTHER
						8 - NEGATIVE RESULTS



OCCUPANT / WITNESS ADDENDUM

LOCAL REPORT NUMBER
2024 - 00005682

OCCUPANT	UNIT # 01	NAME: LAST, FIRST, MIDDLE UNKNOWN,			DATE OF BIRTH		AGE	GENDER	
	ADDRESS: STREET, CITY, STATE, ZIP				CONTACT PHONE - INCLUDE AREA CODE				
	INJURIES 5	INJURED TAKEN BY	EMS AGENCY (NAME)	INJURED TAKEN TO: MEDICAL FACILITY (NAME, CITY)	SAFETY EQUIPMENT USED 99	<input type="checkbox"/> DOT-COMPLIANT MC HELMET	SEATING POSITION 99	AIR BAG USAGE 9	EJECTION 1
OCCUPANT	UNIT #	NAME: LAST, FIRST, MIDDLE			DATE OF BIRTH		AGE	GENDER	
	ADDRESS: STREET, CITY, STATE, ZIP				CONTACT PHONE - INCLUDE AREA CODE				
	INJURIES	INJURED TAKEN BY	EMS AGENCY (NAME)	INJURED TAKEN TO: MEDICAL FACILITY (NAME, CITY)	SAFETY EQUIPMENT USED	<input type="checkbox"/> DOT-COMPLIANT MC HELMET	SEATING POSITION	AIR BAG USAGE	EJECTION
OCCUPANT	UNIT #	NAME: LAST, FIRST, MIDDLE			DATE OF BIRTH		AGE	GENDER	
	ADDRESS: STREET, CITY, STATE, ZIP				CONTACT PHONE - INCLUDE AREA CODE				
	INJURIES	INJURED TAKEN BY	EMS AGENCY (NAME)	INJURED TAKEN TO: MEDICAL FACILITY (NAME, CITY)	SAFETY EQUIPMENT USED	<input type="checkbox"/> DOT-COMPLIANT MC HELMET	SEATING POSITION	AIR BAG USAGE	EJECTION
OCCUPANT	UNIT #	NAME: LAST, FIRST, MIDDLE			DATE OF BIRTH		AGE	GENDER	
	ADDRESS: STREET, CITY, STATE, ZIP				CONTACT PHONE - INCLUDE AREA CODE				
	INJURIES	INJURED TAKEN BY	EMS AGENCY (NAME)	INJURED TAKEN TO: MEDICAL FACILITY (NAME, CITY)	SAFETY EQUIPMENT USED	<input type="checkbox"/> DOT-COMPLIANT MC HELMET	SEATING POSITION	AIR BAG USAGE	EJECTION

INJURIES	SAFETY EQUIPMENT USED	SEATING POSITION	AIR BAG USAGE
1 - FATAL	1 - NONE USED - VEHICLE OCCUPANT	1 - FRONT - LEFT SIDE (MOTORCYCLE DRIVER)	1 - NOT DEPLOYED
2 - SUSPECTED SERIOUS INJURY	2 - SHOULDER BELT ONLY USED	2 - FRONT - MIDDLE	2 - DEPLOYED FRONT
3 - SUSPECTED MINOR INJURY	3 - LAP BELT ONLY USED	3 - FRONT - RIGHT SIDE	3 - DEPLOYED SIDE
4 - POSSIBLE INJURY	4 - SHOULDER & LAP BELT USED	4 - SECOND - LEFT SIDE (MOTORCYCLE PASSENGER)	4 - DEPLOYED BOTH FRONT/SIDE
5 - NO APPARENT INJURY	5 - CHILD RESTRAINT SYSTEM - FORWARD FACING	5 - SECOND - MIDDLE	5 - NOT APPLICABLE
INJURED TAKEN BY		6 - SECOND - RIGHT SIDE	9 - DEPLOYMENT UNKNOWN
1 - NOT TRANSPORTED / TREATED AT SCENE	6 - CHILD RESTRAINT SYSTEM - REAR FACING	7 - THIRD - LEFT SIDE (MOTORCYCLE SIDE CAR)	EJECTION
2 - EMS	7 - BOOSTER SEAT	8 - THIRD - MIDDLE	1 - NOT EJECTED
3 - POLICE	8 - HELMET USED	9 - THIRD - RIGHT SIDE	2 - PARTIALLY EJECTED
9 - OTHER / UNKNOWN	9 - PROTECTIVE PADS USED (ELBOW, KNEES, ETC.)	10 - SLEEPER SECTION OF TRUCK CAB	3 - TOTALLY EJECTED
GENDER		11 - PASSENGER IN OTHER ENCLOSED CARGO AREA (NON-TRAILING UNIT, BUS, PICK-UP WITH CAP)	4 - NOT APPLICABLE
F - FEMALE	10 - REFLECTIVE CLOTHING	12 - PASSENGER IN UNENCLOSED CARGO AREA	TRAPPED
M - MALE	11 - LIGHTING - PEDESTRIAN / BICYCLE ONLY	13 - TRAILING UNIT	1 - NOT TRAPPED
U - OTHER / UNKNOWN	99 - OTHER / UNKNOWN	14 - RIDING ON VEHICLE EXTERIOR (NON-TRAILING UNIT)	2 - EXTRICATED BY MECHANICAL MEANS
		15 - NON-MOTORIST	3 - FREED BY NON-MECHANICAL MEANS
		99 - OTHER / UNKNOWN	

WITNESS	NAME: LAST, FIRST, MIDDLE			DATE OF BIRTH		AGE	GENDER	
	ADDRESS: STREET, CITY, STATE, ZIP				CONTACT PHONE - INCLUDE AREA CODE			
	NAME: LAST, FIRST, MIDDLE			DATE OF BIRTH		AGE	GENDER	
WITNESS	NAME: LAST, FIRST, MIDDLE			DATE OF BIRTH		AGE	GENDER	
	ADDRESS: STREET, CITY, STATE, ZIP				CONTACT PHONE - INCLUDE AREA CODE			
	NAME: LAST, FIRST, MIDDLE			DATE OF BIRTH		AGE	GENDER	
WITNESS	NAME: LAST, FIRST, MIDDLE			DATE OF BIRTH		AGE	GENDER	
	ADDRESS: STREET, CITY, STATE, ZIP				CONTACT PHONE - INCLUDE AREA CODE			

OHIO TRAFFIC ACCIDENT – DIAGRAM/NARRATIVE CONTINUATION

OH-2 (Rev. 1/82)

LOCAL REPORT NUMBER 2024-00005682	REPORTING AGENCY Bellbrook Police	DATE OF ACCIDENT M 07 D 01 Y 2024
IN COUNTY OF 29 Greene	ACCIDENT LOCATION WILMINGTON DAYTON RD Road	

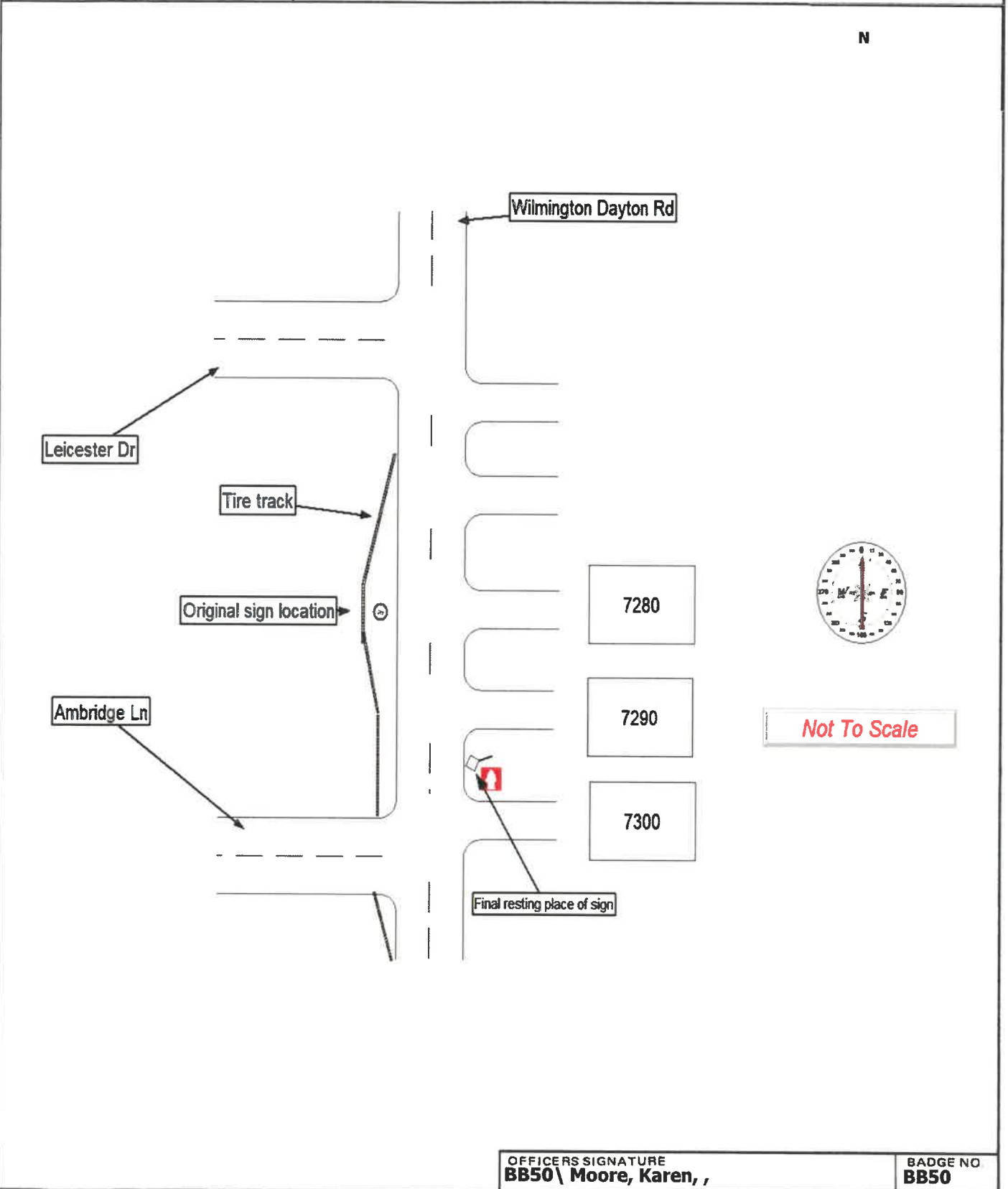

OFFICERS SIGNATURE
BB50 \ Moore, Karen, ,

BADGE NO.
BB50